

**Effective Year 2025 Proposed
Taxing District Boundary Change**







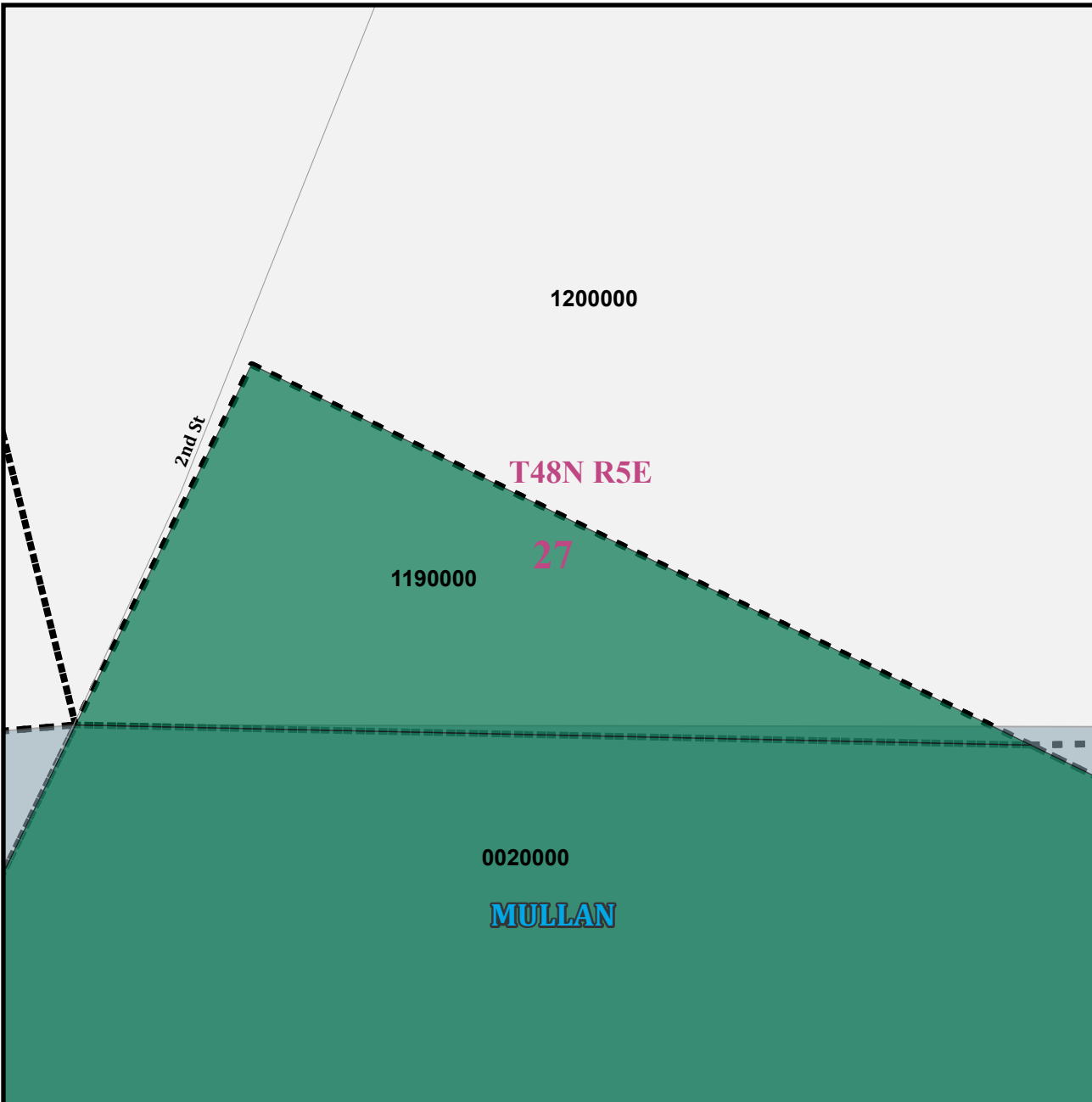

District: MULLAN
County: SHOSHONE
Type: CITY
ISTC Document Number: 64
ISTC Document Name:
 ord_357
Document Date: 4/9/2012

Tax Code Area Change(s):

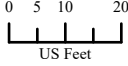
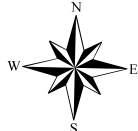
From: 0020000
To: 0020000 (NO CHANGE)

Taxing District Type	Highway	 	<small>Idaho State Tax Commission GIS Date: 5/1/2024 Coordinate System: NAD 1983 Idaho TM Projection: Transverse Mercator Datum: North American 1983 Map Units: Meter</small>	
Tax Code Areas	Street			
PLSS	Water	<small>This map is only a representation of Tax Code Area boundaries and should not be used for legal or surveying applications.</small>		
Interstate				



 Taxing District Type	 Highway	 
 Tax Code Areas	 Street	
 PLSS	 Water	<p>Idaho State Tax Commission GIS Date: 5/1/2024 Coordinate System: NAD 1983 Idaho TM Projection: Transverse Mercator Datum: North American 1983 Map Units: Meter</p> <p><small>This map is only a representation of Tax Code Area boundaries and should not be used for legal or surveying applications.</small></p>
 Interstate		

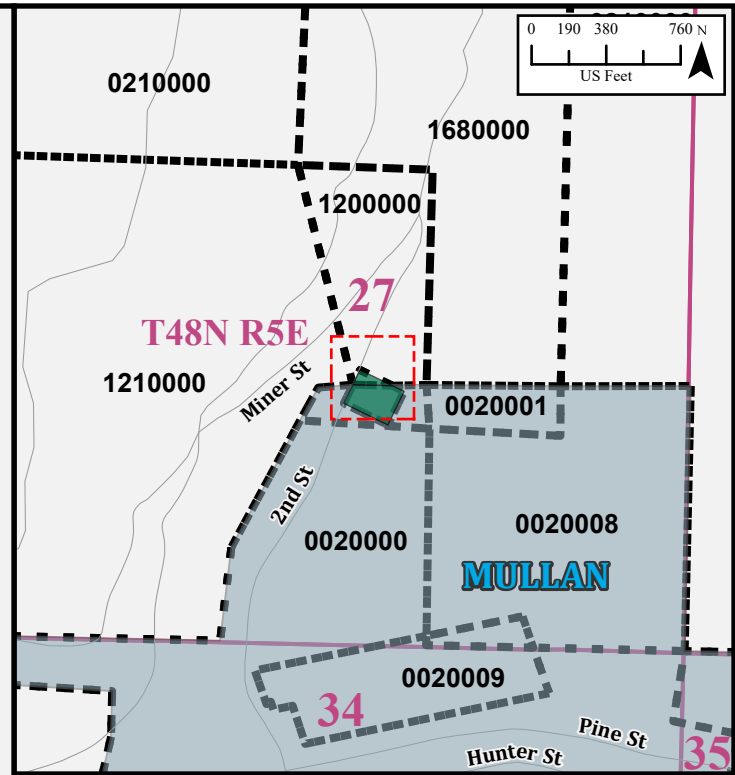

Effective Year 2025 Proposed
Taxing District Boundary Change

District: MULLAN
County: SHOSHONE
Type: CITY
ISTC Document Number: 64
ISTC Document Name: ord_357
Document Date: 4/9/2012

Tax Code Area Change(s):

From: 1190000
To: 0020000 (ENLARGE)