

LEGISLATURE OF THE STATE OF IDAHO
Sixty-seventh Legislature Second Regular Session - 2024

IN THE HOUSE OF REPRESENTATIVES

HOUSE BILL NO. 646

BY STATE AFFAIRS COMMITTEE

AN ACT

RELATING TO COUNTIES; AMENDING SECTION 31-107, IDAHO CODE, TO REVISE PROVISIONS REGARDING THE BOUNDARIES OF BENEWAH COUNTY AND TO MAKE A TECHNICAL CORRECTION; AMENDING SECTION 31-111, IDAHO CODE, TO REVISE PROVISIONS REGARDING THE BOUNDARIES OF BONNER COUNTY; AMENDING SECTION 31-120, IDAHO CODE, TO REVISE PROVISIONS REGARDING THE BOUNDARIES OF CLEARWATER COUNTY AND TO MAKE A TECHNICAL CORRECTION; AMENDING SECTION 31-130, IDAHO CODE, TO REVISE PROVISIONS REGARDING THE BOUNDARIES OF KOOTENAI COUNTY AND TO MAKE A TECHNICAL CORRECTION; AMENDING SECTION 31-131, IDAHO CODE, TO REVISE PROVISIONS REGARDING THE BOUNDARIES OF LATAH COUNTY AND TO MAKE TECHNICAL CORRECTIONS; AMENDING SECTION 31-142, IDAHO CODE, TO REVISE PROVISIONS REGARDING THE BOUNDARIES OF SHOSHONE COUNTY AND TO MAKE A TECHNICAL CORRECTION; AND DECLARING AN EMERGENCY.

Be It Enacted by the Legislature of the State of Idaho:

SECTION 1. That Section 31-107, Idaho Code, be, and the same is hereby amended to read as follows:

31-107. BENEWAH COUNTY. Benewah county is described as follows: beginning at the point of intersection of the Idaho-Washington state line with the north boundary line of township forty-six (46) north;

Western boundary. Thence south along said state line to the point of intersection of said state line with the north boundary line of the county of Latah, as now constituted;

Southern boundary. Thence in a southeasterly and easterly direction along said north boundary line of the county of Latah to ~~the point of intersection of said north boundary line of Latah county with the west boundary line of the county of Shoshone, as the same is now constituted~~ the northeast corner of section four (4), township forty-two (42) north, range one (1) east, being the northeast corner of Latah county with Benewah county to the north and Shoshone county to the east;

Thence east along the township line, approximately 15.50 chains (1,023 feet) to the west sixteenth corner of section thirty-four (34), township forty-three (43) north, range one (1) east, being the southeast corner of Benewah county with Shoshone county to the east and south;

Eastern boundary. Thence along said west boundary line of Shoshone county to the point of intersection of said west boundary line of Shoshone county with the north boundary line of section twenty-two (22), township forty-seven (47) north, range one (1) east Thence north along the western boundary of Shoshone county to the northeast corner section twenty-one (21), township forty-seven (47) north, range one (1) east, being the northeast corner of Benewah county with Kootenai county to the north and Shoshone county to the east;

1 Northern boundary. Thence west along the north boundary line of sec-
 2 tions ~~twenty-two (22)~~, twenty-one (21), twenty (20) and nineteen (19),
 3 township forty-seven (47) north, range one (1) east, to the point of inter-
 4 section with the Boise meridian; thence along said Boise meridian to the
 5 northeast corner of section twenty-four (24), township forty-seven (47)
 6 north, range one (1) west; thence west along the north boundary line of
 7 sections twenty-four (24), twenty-three (23), twenty-two (22), twenty-one
 8 (21), twenty (20) and nineteen (19), township forty-seven (47) north, range
 9 one (1) west, to the range line between township forty-seven (47) north,
 10 range one (1) west, and township forty-seven (47) north, range two (2)
 11 west; thence along said last-mentioned range line to the northeast corner
 12 of section twenty-four (24), township forty-seven (47) north, range two
 13 (2) west; thence continuing west along the north boundary lines of sections
 14 twenty-four (24), twenty-three (23), twenty-two (22), to the northwest
 15 corner of section twenty-two (22), township forty-seven (47) north, range
 16 two (2) west; thence south along the west line of section twenty-two (22),
 17 township forty-seven (47) north, range two (2) west, to the northwest corner
 18 of section twenty-seven (27), township forty-seven (47) north, range two
 19 (2) west; thence west along the north line of sections twenty-eight (28)
 20 and twenty-nine (29), township forty-seven (47) north, range two (2) west,
 21 to the northwest corner of section twenty-nine (29), township forty-seven
 22 (47) north, range two (2) west; thence south along the west line of sections
 23 twenty-nine (29) and thirty-two (32), township forty-seven (47) north,
 24 range two (2) west, to the southwest corner of section thirty-two (32), town-
 25 ship forty-seven (47) north, range two (2) west; thence west along the town-
 26 ship line between townships forty-six (46) and forty-seven (47) north, range
 27 two (2) west, to the intersection of the range line between ranges two (2)
 28 and three (3) west; thence continuing west along the township line between
 29 townships forty-six (46) and forty-seven (47) north, range three (3) west,
 30 to the southwest corner of section thirty-three (33), township forty-seven
 31 (47) north, range three (3) west; thence north along the west line of section
 32 thirty-three (33), township forty-seven (47) north, range three (3) west,
 33 to the northwest corner of section thirty-three (33), township forty-seven
 34 (47) north, range three (3) west; thence west along the north line of sec-
 35 tions thirty-two (32) and thirty-one (31), township forty-seven (47) north,
 36 range three (3) west, to the range line between ranges three (3) and four (4)
 37 west; thence south along the said range line to the northeast corner of sec-
 38 tion thirty-six (36), township forty-seven (47) north, range four (4) west;
 39 thence west along the north line of sections thirty-six (36) and thirty-five
 40 (35), township forty-seven (47) north, range four (4) west, to the northwest
 41 corner of section thirty-five (35), township forty-seven (47) north, range
 42 four (4) west; thence south along the west line of said section thirty-five
 43 (35), township forty-seven (47) north, range four (4) west, to the southwest
 44 corner of said section thirty-five (35), township forty-seven (47) north,
 45 range four (4) west; thence west along the north line of township forty-six
 46 (46) north, ranges four (4), five (5), and six (6) west, to the point of be-
 47 ginning.

48 County seat--St. Maries.

49 SECTION 2. That Section 31-111, Idaho Code, be, and the same is hereby
 50 amended to read as follows:

1 31-111. **BONNER COUNTY**. Bonner county is described as follows: begin-
 2 ning at a point where the township line between townships fifty-three (53)
 3 and fifty-four (54) north intersects the boundary line between the state of
 4 Idaho and the state of Washington;

5 Southern boundary. **Thence** east on said township line between townships
 6 fifty-three (53) and fifty-four (54) north, to the northeast corner of town-
 7 ship fifty-three (53) north, range three (3) west; **thence** north on the range
 8 line between sections thirty-six (36) and thirty-one (31), to the northeast
 9 corner of section thirty-six (36), township fifty-four (54) north, range
 10 three (3) west; **thence** east six (6) miles to the northeast corner of sec-
 11 tion thirty-six (36), township fifty-four (54) north, range two (2) west;
 12 **thence** south along the range line between ranges one (1) and two (2) west,
 13 to the southwest corner of township fifty-three (53) north, range one (1)
 14 west; **thence** east on the township line between townships fifty-two (52)
 15 and fifty-three (53) north, to the ~~present county line between Kootenai and~~
 16 ~~Shoshone counties~~ northeast corner of section four (4), township fifty-two
 17 (52) north, range one (1) east, being the northeast corner of Kootenai county
 18 with Shoshone county to the east and Bonner county to the north;

19 **Thence** east on said township line approximately 32.24 chains (2,128
 20 feet) to the south quarter corner of section thirty-four (34), township
 21 fifty-three (53) north, range one (1) east, being the southeast corner of
 22 Bonner county with Shoshone county to the south and east;

23 ~~thence~~ **Thence** north along the west boundary line of Shoshone county to
 24 the northwest corner thereof; **thence** in an easterly direction along the sum-
 25 mit of the Coeur d'Alene range of mountains to the west line of the state of
 26 Montana;

27 Eastern boundary. **Thence** north along the boundary line between the
 28 state of Idaho and the state of Montana (R.C., section 23g) to a point where
 29 the south line of township sixty (60) north of range three (3) east inter-
 30 sects the boundary line between the state of Idaho and the state of Montana;

31 Northern boundary. **Thence** west along said south line of township sixty
 32 (60) through ranges three (3), two (2), and one (1) east, and ranges one (1),
 33 two (2), and three (3) west, to the southwest corner of township sixty (60)
 34 north, range three (3) west; **thence** north along the range line between ranges
 35 three (3) and four (4) west, to the point where the north line of township
 36 sixty-three (63) north, intersects the range line between ranges three (3)
 37 and four (4) west; **thence** west along the said north line of township sixty-
 38 three (63) north, ranges four (4) and five (5) west, to a point on the state
 39 line between the states of Idaho and Washington where the same is intersected
 40 by the said north line of township sixty-three (63) north, range five (5)
 41 west (1915, ch. 7, section 2, p. 21);

42 Western boundary. **Thence** south along the boundary line between the
 43 state of Idaho and the state of Washington to the place of beginning (R.C.,
 44 section 23g).

45 County seat--Sandpoint.

46 SECTION 3. That Section 31-120, Idaho Code, be, and the same is hereby
 47 amended to read as follows:

48 31-120. **CLEARWATER COUNTY**. Clearwater county is described as follows:
 49 beginning at the mouth of Lolo creek;

1 Southern boundary. Thence in a northeasterly direction up the middle of
 2 the channel to the head of said Lolo creek; thence northeasterly in a direct
 3 line to a point where the Montana-Idaho state line intersects the Lolo pass
 4 at the summit of the ~~Bitter Root~~ Bitterroot mountains;

5 Eastern boundary. Thence in a northwesterly direction along said Mon-
 6 tana-Idaho state line to the intersection of the same with the northern
 7 boundary of township forty-one (41) north;

8 Northern boundary. Thence west along said northern boundary line to a
 9 ~~point directly north of the mouth of the North Fork of Clearwater river the~~
 10 north quarter corner of section three (3), township forty-one (41) north,
 11 range one (1) east, being the northeast corner of Clearwater county with
 12 Shoshone county to the north and Latah county to the west;

13 Western boundary. Thence south ~~to a point of intersection with the~~
 14 ~~middle line of township thirty-eight (38) north along midsection lines, ap-~~
 15 ~~proximately 6 miles to the south quarter corner of section thirty-four (34),~~
 16 township forty-one (41) north, range one (1) east;

17 Thence west along the township line, approximately 22.8 chains (1,505
 18 feet) to the west sixteenth corner of section three (3), township forty (40)
 19 north, range one (1) east;

20 Thence south along sixteenth section subdivision lines, approximately
 21 1 mile to the west sixteenth corner of sections three (3) and ten (10), town-
 22 ship forty (40) north, range one (1) east;

23 Thence west along the section line, 90 feet to a duly surveyed property
 24 corner monument;

25 Thence south along the property line, approximately 1 quarter mile to a
 26 duly surveyed property corner monument;

27 Thence east along the section subdivision line, 90 feet to the northwest
 28 sixteenth corner of section ten (10), township forty (40) north, range one
 29 (1) east;

30 Thence south along sixteenth section subdivision lines, approximately
 31 4 and 3 quarter miles to the west sixteenth corner of sections thirty-four
 32 (34) and three (3), townships forty (40) north and thirty-nine (39) north,
 33 range one (1) east;

34 Thence west along the township line, approximately 90 feet to an unmonu-
 35 mented point;

36 Thence south approximately 1 half mile to a duly surveyed property cor-
 37 ner monument;

38 Thence south approximately 1 half mile to a duly surveyed property cor-
 39 ner on the south line of section three (3), township thirty-nine (39) north,
 40 range one (1) east;

41 Thence west along the section line approximately 1230 feet to the north-
 42 east corner of section 9, township thirty-nine (39) north, range one (1)
 43 east;

44 Thence south along section lines, approximately 5 miles to the south-
 45 east corner of section thirty-three (33), township thirty-nine (39) north,
 46 range one (1) east;

47 Thence east along the township line, approximately 5.83 chains (385
 48 feet) to the northeast corner of section four (4), township thirty-eight
 49 (38) north, range one (1) east;

1 Thence south along section lines, approximately 3 miles to the middle
 2 line of the township, and the southeast corner of section sixteen (16), town-
 3 ship thirty-eight (38) north, range one (1) east, being the southeast cor-
 4 ner of Latah county with Clearwater county to the east and south; thence west
 5 along said middle line of township thirty-eight (38) north, to the north-
 6 west corner of section twenty-two (22), township thirty-eight (38) north,
 7 range one (1) west; thence south to the north boundary line of the Nez Perce
 8 Indian reservation; thence easterly along said reservation line to the in-
 9 tersection of the same with the line running south between sections fifteen
 10 (15) and sixteen (16), township thirty-seven (37) north, range one (1) west;
 11 thence south on the said line between sections fifteen (15) and sixteen (16)
 12 to the middle of the channel of Clearwater river; thence up the middle of the
 13 channel of said Clearwater river to a point where the same is intersected by
 14 the section line between sections five (5) and six (6), township thirty-six
 15 (36) north, range one (1) east; thence south on the section line between said
 16 sections five (5) and six (6) to the middle of the channel of Little Canyon
 17 creek; thence up the middle of the channel of Little Canyon creek to a point
 18 where the same intersects the seventh (7th) standard parallel north; thence
 19 east along said parallel to the middle of the channel of Clearwater river;
 20 thence up the middle of the channel of said Clearwater river to the point of
 21 beginning.

22 County seat--Orofino.

23 SECTION 4. That Section 31-130, Idaho Code, be, and the same is hereby
 24 amended to read as follows:

25 31-130. KOOTENAI COUNTY. Kootenai county is described as follows: be-
 26 ginning at the point of intersection of the west boundary line of Shoshone
 27 county with the north boundary line of section twenty-two (22), the south
 28 quarter of section fifteen (15), township forty-seven (47) north, range one
 29 (1) east, being the southeast corner of Kootenai county with Shoshone county
 30 to the east and south;

31 Southern boundary. Thence west along the north boundary line of sec-
 32 tions twenty-two (22), approximately 1 half mile to the northwest corner
 33 of section twenty-two (22), township forty-seven (47) north, range one (1)
 34 east, being the northeast corner of Benewah county with Kootenai county
 35 to the north and Shoshone county to the east; thence west along the north
 36 boundary line of sections twenty-one (21), twenty (20) and nineteen (19),
 37 township forty-seven (47) north, range one (1) east, to the point of inter-
 38 section with the Boise meridian; thence along said Boise meridian, to the
 39 northeast corner of section twenty-four (24), township forty-seven (47)
 40 north, range one (1) west; thence west along the north boundary line of
 41 sections twenty-four (24), twenty-three (23), twenty-two (22), twenty-one
 42 (21), twenty (20) and nineteen (19), township forty-seven (47) north, range
 43 one (1) west, to the range line between township forty-seven (47) north,
 44 range one (1) west, and township forty-seven (47) north, range two (2)
 45 west; thence along said last mentioned range line to the northeast corner
 46 of section twenty-four (24), township forty-seven (47) north, range two
 47 (2) west; thence continuing west along the north boundary lines of sections
 48 twenty-four (24), twenty-three (23), twenty-two (22), to the northwest
 49 corner of section twenty-two (22), township forty-seven (47) north, range

1 two (2) west; thence south along the west line of section twenty-two (22),
 2 township forty-seven (47) north, range two (2) west, to the northwest corner
 3 of section twenty-seven (27), township forty-seven (47) north, range two
 4 (2) west; thence west along the north line of sections twenty-eight (28)
 5 and twenty-nine (29), township forty-seven (47) north, range two (2) west,
 6 to the northwest corner of section twenty-nine (29), township forty-seven
 7 (47) north, range two (2) west; thence south along the west line of sections
 8 twenty-nine (29) and thirty-two (32), township forty-seven (47) north,
 9 range two (2) west, to the southwest corner of section thirty-two (32), town-
 10 ship forty-seven (47) north, range two (2) west; thence west along the town-
 11 ship line between townships forty-six (46) and forty-seven (47) north, range
 12 two (2) west, to the intersection of the range line between ranges two (2)
 13 and three (3) west; thence continuing west along the township line between
 14 townships forty-six (46) and forty-seven (47) north, range three (3) west,
 15 to the southwest corner of section thirty-three (33), township forty-seven
 16 (47) north, range three (3) west; thence north along the west line of section
 17 thirty-three (33), township forty-seven (47) north, range three (3) west,
 18 to the northwest corner of section thirty-three (33), township forty-seven
 19 (47) north, range three (3) west; thence west along the north line of sec-
 20 tions thirty-two (32) and thirty-one (31), township forty-seven (47) north,
 21 range three (3) west, to the range line between ranges three (3) and four
 22 (4) west; thence south along said range line to the northeast corner of sec-
 23 tion thirty-six (36), township forty-seven (47) north, range four (4) west;
 24 thence west along the north line of section thirty-six (36) and thirty-five
 25 (35), township forty-seven (47) north, range four (4) west, to the northwest
 26 corner of section thirty-five (35), township forty-seven (47) north, range
 27 four (4) west; thence south along the west line of said section thirty-five
 28 (35), township forty-seven (47) north, range four (4) west, to the southwest
 29 corner of said section thirty-five (35), township forty-seven (47) north,
 30 range four (4) west; thence west along the north line of township forty-six
 31 (46) north, ranges four (4), five (5) and six (6) west (1915, ch. 4, section
 32 3, pp. 7, 8), to the point of intersection of the Idaho-Washington state line
 33 with the northern boundary line of township forty-six (46) north of the Boise
 34 base line;

35 Western boundary. Thence north along said state boundary line to
 36 a point where the same is intersected by the line between townships
 37 fifty-three (53) and fifty-four (54) north;

38 Northern boundary. Thence east along said township line between town-
 39 ships fifty-three (53) and fifty-four (54) north, to the northeast corner
 40 of township fifty-three (53) north, range three (3) west; thence north on
 41 the range line between sections thirty-six (36) and thirty-one (31), to
 42 the northeast corner of section thirty-six (36), township fifty-four (54)
 43 north, range three (3) west; thence east six (6) miles, to the northeast
 44 corner of section thirty-six (36), township fifty-four (54) north, range two
 45 (2) west; thence south along the range line between ranges one (1) and two
 46 (2) west, to the southwest corner of township fifty-three (53) north, range
 47 one (1) west; thence east on the township line between townships fifty-two
 48 (52) and fifty-three (53) north, to ~~the intersection of the said line with~~
 49 ~~the western boundary of Shoshone county (1909, p. 318)~~ the northeast cor-
 50 ner of section four (4), township fifty-two (52), range one (1) east, being

1 the northeast corner of Kootenai county with Bonner county to the north and
 2 Shoshone county to the east;

3 Eastern boundary. Thence south along the western boundary of Shoshone
 4 county, to the south quarter corner of section fifteen (15), township forty-
 5 seven (47) north, range one (1) east, and the point of beginning (1915, ch.
 6 4, section 2, p. 6).

7 County seat--Coeur d'Alene.

8 SECTION 5. That Section 31-131, Idaho Code, be, and the same is hereby
 9 amended to read as follows:

10 31-131. LATAH COUNTY. Latah county is described as follows: beginning
 11 at a point where the middle line of township thirty-seven (37) north inter-
 12 sects the boundary line between the state of Idaho and the state of Washing-
 13 ton;

14 Western boundary. Thence north along the said boundary line to a point
 15 where the watershed between Hangman's creek and Palouse river crosses the
 16 said boundary line;

17 Northern boundary. Thence in a southeasterly direction along the said
 18 watershed to a point where this line crosses the section line between sec-
 19 tions twenty-seven (27) and twenty-eight (28), township forty-three (43)
 20 north, range four (4) west; thence south on the said section line to the
 21 section corner common to sections twenty-seven (27), twenty-eight (28),
 22 thirty-three (33) and thirty-four (34), in the same township and range;
 23 thence east on this section line to the eastern boundary of the said town-
 24 ship and range; thence north on the range line to the northwest corner of
 25 section thirty-one (31), township forty-three (43) north, range three (3)
 26 west; thence east along the section line running on the north of said section
 27 thirty-one (31), to the northeast corner of section thirty-three (33), town-
 28 ship forty-three (43) north, range one (1) west; thence south one (1) mile,
 29 to the township line between townships forty-two (42) and forty-three (43)
 30 north; thence east along the said township line ~~to a point directly north of~~
 31 ~~the mouth of the North Fork of the Clearwater river~~ approximately 6 miles
 32 to the northeast corner of section four (4), township forty-two (42) north,
 33 range one (1) east, being the northeast corner of Latah county with Benewah
 34 county to the north and Shoshone county to the east;

35 Eastern boundary. Thence south ~~to the middle line of township thirty-~~
 36 ~~eight (38) north~~ along the section lines, approximately 2 miles to the south-
 37 east corner of section nine (9), township forty-two (42) north, range one (1)
 38 east;

39 Thence east along the section line, approximately 1 half mile to the
 40 north quarter corner of section fifteen (15), township forty-two (42) north,
 41 range one (1) east;

42 Thence south along the midsection line, approximately 2 miles to the
 43 south quarter corner of section twenty-two (22), township forty-two (42)
 44 north, range one (1) east;

45 Thence west along the section line, approximately 1 quarter mile to the
 46 west sixteenth corner of sections twenty-two (22) and twenty-seven (27),
 47 township forty-two (42) north, range one (1) east;

48 Thence west along the section line, 90 feet to a duly surveyed property
 49 corner monument;

1 Thence south along the property line, approximately 1 half mile to a
2 duly surveyed property corner monument;

3 Thence east along the section subdivision line, 90 feet to the center
4 west sixteenth corner of section twenty-seven (27);

5 Thence south along sixteenth section subdivision lines, approximately
6 1 and 1 half miles to the west sixteenth corner of sections thirty-four (34)
7 and three (3), township forty-two (42) north and township forty-one (41)
8 north, range one (1) east;

9 Thence east along the township line, approximately 1 quarter mile to the
10 north quarter corner of section three (3), township forty-one (41) north,
11 range one (1) east, being the northwest corner of Clearwater county with
12 Shoshone county to the north and Latah county to the west;

13 Thence south along midsection lines, approximately 6 miles to the south
14 quarter corner of section thirty-four (34), township forty-one (41) north,
15 range one (1) east;

16 Thence west along the township line, approximately 22.8 chains (1,505
17 feet) to the west sixteenth corner of section three (3), township forty (40)
18 north, range one (1) east;

19 Thence south along sixteenth section subdivision lines, approximately
20 1 mile to the west sixteenth corner of sections three (3) and ten (10), town-
21 ship forty (40) north, range one (1) east;

22 Thence west along the section line, 90 feet to a duly surveyed property
23 corner monument;

24 Thence south along the property line, approximately 1 quarter mile to a
25 duly surveyed property corner monument;

26 Thence east along the section subdivision line, 90 feet to the northwest
27 sixteenth corner of section ten (10), township forty (40) north, range one
28 (1) east;

29 Thence south along sixteenth section subdivision lines, approximately
30 4 and 3 quarter miles to the west sixteenth corner of sections thirty-four
31 (34) and three (3), townships forty (40) north and thirty-nine (39) north,
32 range one (1) east;

33 Thence west along the township line, approximately 90 feet to an unmonu-
34 mented property corner;

35 Thence south approximately 1 half mile to a duly surveyed property cor-
36 ner monument;

37 Thence south approximately 1 half mile to a duly surveyed property cor-
38 ner on the south line of section three (3), township thirty-nine (39), range
39 one (1) east;

40 Thence west along the section line approximately 1230 feet to the north-
41 east corner of section nine (9), township thirty-nine (39) north, range one
42 (1) east;

43 Thence south along section lines, approximately 5 miles to the south-
44 east corner of section thirty-three (33), township thirty-nine (39) north,
45 range one (1) east;

46 Thence east along the township line, approximately 5.83 chains (385
47 feet) to the northeast corner of section four (4), township thirty-eight
48 (38) north, range one (1) east;

49 Thence south along section lines, approximately 3 miles to the middle
50 line of the township, and the southeast corner of section sixteen (16), town-

1 ship thirty-eight (38) north, range one (1) east, being the southeast corner
 2 of Latah county with Clearwater county to the east and south;

3 Southern boundary. Thence west on the middle line of township
 4 thirty-eight (38) north to the point of intersection of said middle line and
 5 the center of Big Potlatch creek; thence along the average center of said
 6 creek south $41^{\circ}29'00''$ west 433.17 feet; thence south $83^{\circ}01'30''$ west 555.76
 7 feet; thence north $72^{\circ}43'45''$ west 486.51 feet; thence north $41^{\circ}28'30''$ west
 8 762.95 feet; thence north $72^{\circ}52'00''$ west 134.45 feet; to a point which is
 9 north 358.29 feet from the corner common to Sections 16, 17, 20 and 21, town-
 10 ship thirty-eight (38) north, range 2 west, Boise Meridian; thence north
 11 $72^{\circ}52'00''$ west 2007.63 feet; thence south $48^{\circ}22'30''$ west 949.70 feet; thence
 12 north $88^{\circ}25'15''$ west 1485.48 feet; thence south $45^{\circ}57'45''$ west 770.90 feet;
 13 thence north $82^{\circ}46'15''$ west 750.35 feet; thence south $43^{\circ}28'45''$ west 1160.84
 14 feet; thence south $65^{\circ}32'00''$ west 804.18 feet; thence south $46^{\circ}29'30''$ west
 15 527.72 feet; thence south $53^{\circ}01'15''$ west 717.00 feet; to a point which is
 16 south 2073.86 feet from the one-quarter corner common to Sections 18 and 19
 17 township thirty-eight (38) north, range 2 west, Boise Meridian; thence south
 18 $53^{\circ}01'15''$ west 685.19 feet; thence south $30^{\circ}54'30''$ west 1373.34 feet; thence
 19 south $84^{\circ}44'45''$ west 1151.76 feet; thence south $21^{\circ}04'00''$ east 1132.26 feet;
 20 thence south $05^{\circ}04'00''$ west 902.41 feet; thence south $78^{\circ}56'15''$ west 493.86
 21 feet; to a point which is south 657.49 feet from the corner common to Sections
 22 24, 19, 31 and 25, township thirty-eight (38) north, range 3 west and range
 23 2 west, Boise Meridian; thence south $78^{\circ}56'15''$ west 136.97 feet; thence
 24 north $87^{\circ}54'15''$ west 2370.65 feet; thence south $73^{\circ}27'15''$ west 1216.03 feet;
 25 thence south $34^{\circ}56'45''$ west 2443.32 feet; thence south $55^{\circ}35'15''$ west 258.89
 26 feet; to a point which is south 447.50 feet from the one-quarter corner com-
 27 mon to Sections 26 and 25, township thirty-eight (38) north, range 3 west,
 28 Boise Meridian; thence south $55^{\circ}35'15''$ west 2071.08 feet; thence south
 29 $42^{\circ}55'30''$ west 1609.29 feet; to a point which is located west 2811.85 feet
 30 from the corner common to Sections 26, 25, 36 and 35, township thirty-eight
 31 (38) north, range 3 west, Boise Meridian; thence south $44^{\circ}33'29''$ west 950.95
 32 feet; thence south $07^{\circ}36'44''$ west 869.85 feet; thence south $28^{\circ}34'42''$ west
 33 740.46 feet; thence south $30^{\circ}26'40''$ west 397.99 feet; thence south $03^{\circ}38'57''$
 34 west 618.32 feet; thence south $38^{\circ}21'12''$ west 690.57 feet; thence south
 35 $54^{\circ}22'07''$ west 56.90 feet; thence south $69^{\circ}39'54''$ west 343.03 feet; thence
 36 south $82^{\circ}19'22''$ west 333.65 feet; thence south $65^{\circ}55'57''$ west 647.97 feet;
 37 thence south $63^{\circ}14'18''$ west 784.25 feet; thence north $85^{\circ}46'49''$ west 1140.68
 38 feet; thence south $37^{\circ}18'55''$ west 820.62 feet; thence south $30^{\circ}42'01''$
 39 west 840.83 feet; thence south $02^{\circ}55'30''$ east 1395.50 feet; thence south
 40 $10^{\circ}47'35''$ west 233.84 feet; thence south $52^{\circ}26'42''$ west 474.82 feet; thence
 41 south $31^{\circ}23'33''$ west 1307.49 feet; thence south $15^{\circ}45'00''$ west 732.84 feet;
 42 thence south $10^{\circ}27'38''$ east 755.37 feet; to a point which is east 662.51
 43 feet and north $02^{\circ}06'09''$ west 8.57 feet from the corner common to Sections
 44 3, 4, 9 and 10, township thirty-seven (37) north, range 3 west, Boise Merid-
 45 ian, which corner is marked by a Brass Cap Monument set 1556.70 feet east of
 46 said corner set by James W. Grow, R.L.S. #749; thence south $02^{\circ}06'09''$ east
 47 317.10 feet; thence south $11^{\circ}10'52''$ west 528.81 feet; thence south $33^{\circ}23'33''$
 48 west 1343.54 feet; thence south $18^{\circ}47'37''$ east 514.74 feet; thence south
 49 $18^{\circ}33'57''$ west 902.43 feet; thence south $10^{\circ}36'14''$ west 654.11 feet; thence
 50 south $21^{\circ}02'12''$ west 343.00 feet; thence south $31^{\circ}52'33''$ west 896.41 feet;

1 to a point that is west 983.97 feet and north 05°04'43" east 80.67 feet from
 2 the corner common to Sections 9, 10, 15 and 16, township thirty-seven (37)
 3 north, range 3 west, Boise Meridian, being marked by a 5/8" iron pin set in a
 4 mound of stone by James W. Grow, R.L.S. #749, and by a Brass Cap Monument set
 5 1136.66 feet west of said section corner; thence south 05°04'43" west 488.49
 6 feet; thence south 15°20'14" west 272.28 feet; thence south 27°52'57" west
 7 661.93 feet; thence south 57°36'12" west 456.93 feet; thence south 21°50'14"
 8 west 385.38 feet; thence south 12°45'28" east 367.96 feet; thence south
 9 67°00'39" east 464.34 feet; thence south 22°07'05" west 1097.33 feet; thence
 10 south 33°13'49" west 576.62 feet; thence south 13°03'47" east 296.08 feet;
 11 thence south 34°16'41" west 1198.35 feet; thence south 21°36'07" west 183.18
 12 feet; to a point on the north line of Section 21, township thirty-seven (37)
 13 north, range 3 west, Boise Meridian, said point being east 1482.32 feet from
 14 the northwest corner of said Section 21, which corner is marked by a Brass
 15 Cap Monument lying east 1845.18 feet from said corner; thence west along the
 16 middle line of township thirty-seven (37) north to the point of beginning.

17 County Seat--Moscow.

18 SECTION 6. That Section 31-142, Idaho Code, be, and the same is hereby
 19 amended to read as follows:

20 31-142. SHOSHONE COUNTY. Shoshone county is described as follows: be-
 21 ginning at a point where the township line between townships forty-one (41)
 22 and forty-two (42) north, intersects the western boundary of the state of
 23 Montana;

24 Eastern boundary. Thence in a northerly direction along the said bound-
 25 ary and with the ~~Bitter Root~~ Bitterroot range of mountains until the said
 26 range turns in a westerly direction and is called Coeur d'Alene.

27 Northern boundary. Thence with the said Coeur d'Alene range of moun-
 28 tains in a westerly direction until a point is attained ~~north of the mouth of~~
 29 ~~the North Fork of the Clearwater river on the west line of section twenty-two~~
 30 (22), township fifty-four (54) north, range one (1) east, being the north-
 31 west corner of Shoshone county with Bonner county to the north and west;

32 Western boundary. ~~Thence south to the township line between townships~~
 33 ~~forty-one (41) and forty-two (42) north;~~ Thence south along the section
 34 lines, approximately 2 and 3 quarter miles to the southwest corner of section
 35 thirty-four (34), township fifty-four (54) north, range one (1) east;

36 Thence west along the township line, approximately 0.64 chains (42
 37 feet) to the northwest corner of section three (3), township fifty-three
 38 (53) north, range one (1) east;

39 Thence south along the section lines, approximately 2 miles to the
 40 southwest corner of section ten (10), township fifty-three (53) north, range
 41 one (1) east;

42 Thence east along the section line, approximately 1 half mile to the
 43 south quarter corner of section ten (10), township fifty-three (53) north,
 44 range one (1) east;

45 Thence south along the midsection lines, approximately 4 miles to the
 46 south quarter corner of section thirty-four (34), township fifty-three (53)
 47 north, range one (1) east, being the southeast corner of Bonner county with
 48 Shoshone county to the south and east;

1 Thence west along the township line, approximately 32.24 chains (2,128
2 feet) to the northwest corner of section three (3), township fifty-two (52)
3 north, range one (1) east, being the northeast corner of Kootenai county with
4 Bonner county to the north and Shoshone county to the east;

5 Thence south along the section lines, approximately 12 miles to the
6 southwest corner of section thirty-four (34), township fifty-one (51)
7 north, range one (1) east;

8 Thence east along the township line, approximately 1 half mile to the
9 north quarter corner of section three (3), township fifty (50) north, range
10 one (1) east;

11 Thence south along the midsection lines, approximately 6 miles to the
12 south quarter corner of section thirty-four (34), township fifty (50) north,
13 range one (1) east;

14 Thence west along the township line, approximately 3.74 chains (247
15 feet) to the north quarter corner of section three (3), township forty-nine
16 (49) north, range one (1) east;

17 Thence south along the midsection lines, approximately 2 miles to the
18 south quarter corner of section ten (10), township forty-nine (49) north,
19 range one (1) east;

20 Thence west along the section line, approximately 1 quarter mile to the
21 west sixteenth corner of sections ten (10) and fifteen (15), township forty-
22 nine (49) north, range one (1) east;

23 Thence south along the sixteenth section subdivision lines, approx-
24 imately 4 miles to the west sixteenth corner of section thirty-four (34),
25 township forty-nine (49) north, range one (1) east;

26 Thence west along the township line, approximately 3.40 chains
27 (224 feet) to the west sixteenth corner of section three (3), township
28 forty-eight (48) north, range one (1) east;

29 Thence south along the sixteenth section subdivision lines, approx-
30 imately 5 and 1 half miles to the center west sixteenth corner of section
31 thirty-four (34), township forty-eight (48) north, range one (1) east;

32 Thence west along the section subdivision line, approximately 90 feet
33 to a duly surveyed property corner monument;

34 Thence south along the property line, approximately 1 half mile to a
35 duly surveyed property corner monument on the township line;

36 Thence east along the township line, approximately 90 feet to the west
37 sixteenth corner of section thirty-four (34), township forty-eight (48)
38 north, range one (1) east;

39 Thence east along the township line, approximately 1 quarter mile to the
40 south quarter corner of section thirty-four (34), township forty-eight (48)
41 north, range one (1) east;

42 Thence east along the township line, approximately 1.55 chains (102
43 feet) to the north quarter corner of section three (3), township forty-seven
44 (47) north, range one (1) east;

45 Thence south along the midsection lines, approximately 3 miles to the
46 south quarter corner of section fifteen (15), township forty-seven (47)
47 north, range one (1) east, being the southeast corner of Kootenai county with
48 Shoshone county to the east and south;

49 Thence west along the section line, approximately 1 half mile to the
50 northwest corner of section twenty-two (22), township forty-seven (47)

1 north, range one (1) east, being the northeast corner of Benewah county with
2 Kootenai county to the north and Shoshone county to the east;

3 Thence south along the section lines, approximately 2 miles to the
4 southwest corner of section twenty-seven (27), township forty-seven (47)
5 north, range one (1) east;

6 Thence east along the section line approximately 1 half mile to the
7 south quarter corner of section twenty-seven (27), township forty-seven
8 (47) north, range one (1) east;

9 Thence south along the midsection lines, approximately 4 miles to the
10 south quarter corner of section fifteen (15), township forty-six (46) north,
11 range one (1) east;

12 Thence west along the section line approximately 1 quarter mile to the
13 west sixteenth corner of section fifteen (15) and section twenty-two (22),
14 township forty-six (46) north, range one (1) east;

15 Thence south along the sixteenth section subdivision line, approxi-
16 mately 1 mile to the west sixteenth corner of section twenty-two (22) and
17 section twenty-seven (27), township forty-six (46) north, range one (1)
18 east;

19 Thence east along the section line approximately 1 quarter mile to the
20 north quarter corner of section twenty-seven (27), township forty-six (46)
21 north, range one (1) east;

22 Thence south along the midsection lines, approximately 2 miles to the
23 south quarter corner of section thirty-four (34), township forty-six (46)
24 north, range one (1) east;

25 Thence west along the township line, approximately 1 half mile to the
26 northwest corner of section three (3), township forty-five (45) north, range
27 one (1) east;

28 Thence south along the section lines, approximately 6 miles to the
29 southwest corner of section thirty-four (34), township forty-five (45)
30 north, range one (1) east;

31 Thence east along the township line, approximately 14.24 chains (940
32 feet) to the west sixteenth corner of section three (3), township forty-four
33 (44) north, range one (1) east;

34 Thence south along the sixteenth section subdivision lines, approxi-
35 mately 12 miles to the west sixteenth corner of section thirty-four (34),
36 township forty-three (43) north, range one (1) east, being the southeast
37 corner of Benewah county with Shoshone county to the east and south;

38 Thence west along the township line, approximately 15.50 chains (1,023
39 feet) to the northwest corner of section three (3), township forty-two (42)
40 north, range one (1) east, being the northeast corner of Latah county with
41 Benewah county to the north and Shoshone county to the east;

42 Thence south along the section lines, approximately 2 miles to the
43 southwest corner of section ten (10), township forty-two (42) north, range
44 one (1) east;

45 Thence east along the section line, approximately 1 half mile to the
46 south quarter corner of section ten (10), township forty-two (42) north,
47 range one (1) east;

48 Thence south along the midsection line, approximately 2 miles to the
49 south quarter corner of section twenty-two (22), township forty-two (42)
50 north, range one (1) east;

1 Thence west along the section line, approximately 1 quarter mile to the
2 west sixteenth corner of sections twenty-two (22) and twenty-seven (27);

3 Thence west along the section line, 90 feet to a duly surveyed property
4 corner monument;

5 Thence south along the property line, approximately 1 half mile to a
6 duly surveyed property corner monument;

7 Thence east along the section subdivision line, 90 feet to the center
8 west sixteenth corner of section twenty-seven (27);

9 Thence south along sixteenth section subdivision lines, approximately
10 1 and 1 half miles to the west sixteenth corner of sections thirty-four (34)
11 and three (3), township forty-two (42) north and township forty-one (41)
12 north, range one (1) east, being the southwest corner of Shoshone county with
13 Latah county to the west and Clearwater county to the south;

14 Southern boundary. Thence east on the said township line to the inter-
15 section of the same with the boundary line of the state of Montana, the place
16 of beginning.

17 County seat--Wallace.

18 SECTION 7. An emergency existing therefor, which emergency is hereby
19 declared to exist, this act shall be in full force and effect on and after its
20 passage and approval.

R 01 W

R 01 E

R 02 E

T 55 N

T 54 N

T 53 N

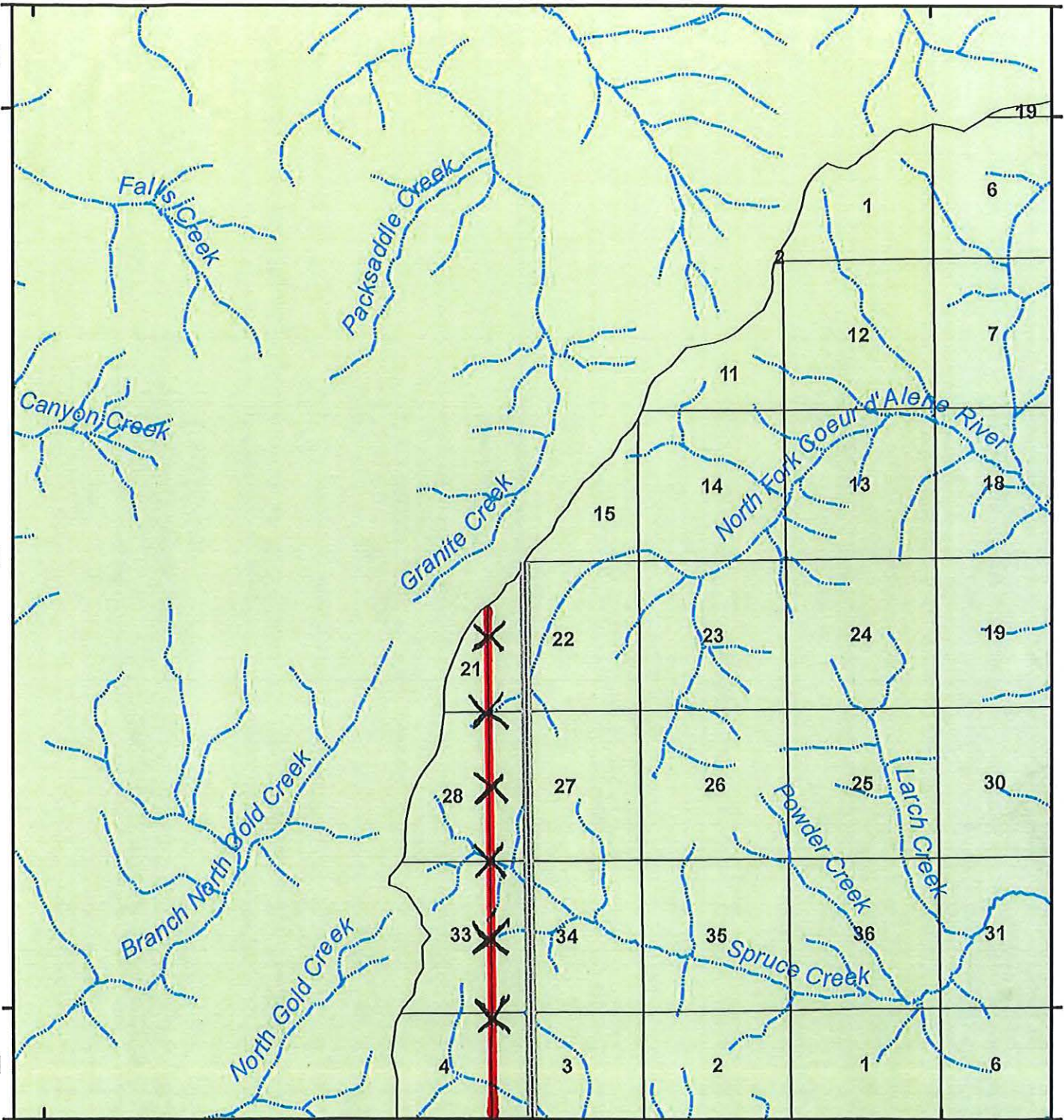

Legend



Known Established Corner



County Roads



Bureau of Land Management



State Fish and Game



Non-highway paved



Private



US Forest Service



State



Estimated County Line



Paved Highway



0 0.75 1.5 Miles



**Banner-Shoshone
Border
T54N R01E**

R 01 W

R 01 E

R 02 E

T 53 N

T 53 N

T 52 N

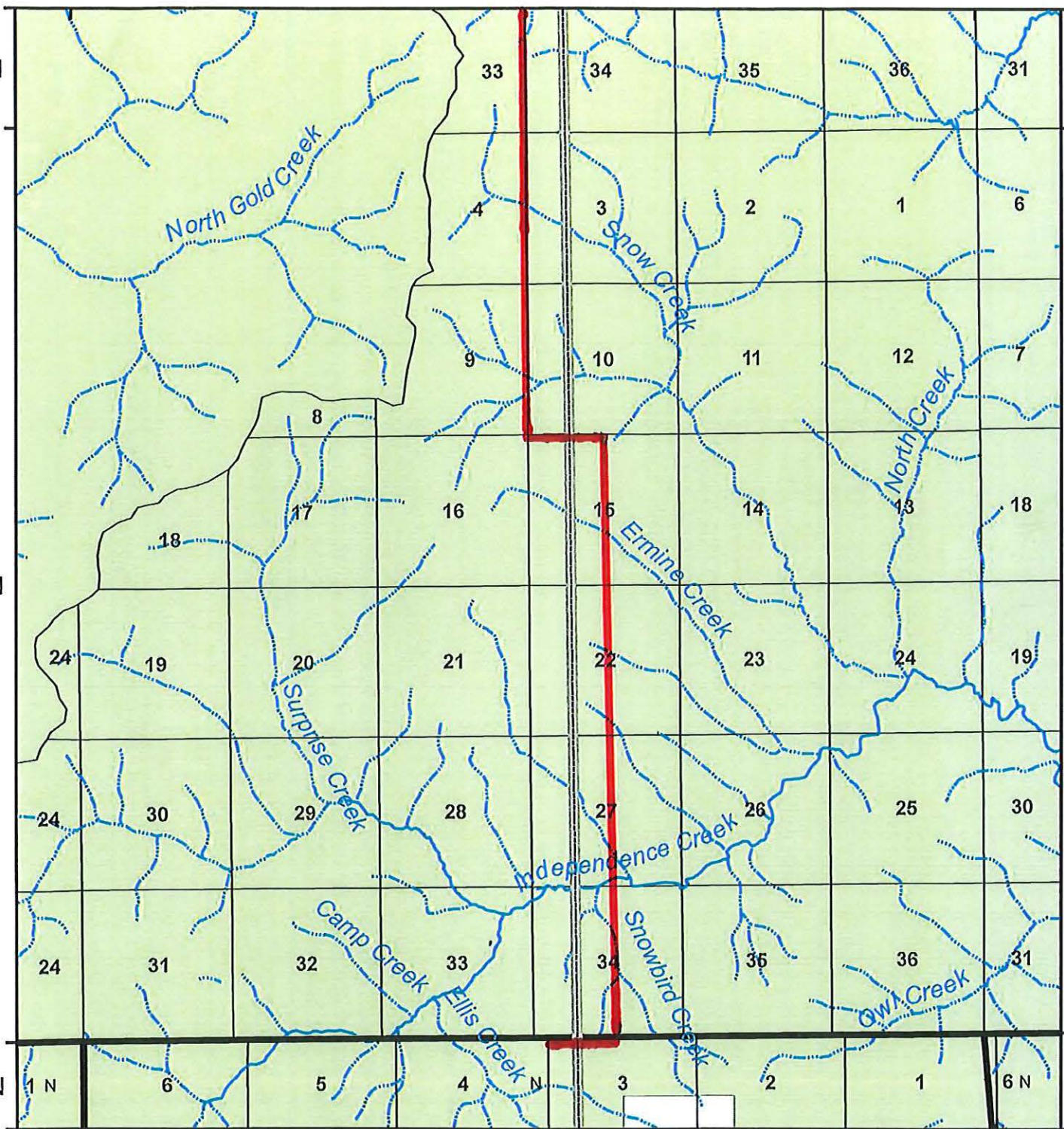

Legend

- Known Established Corner
- Estimated County Line
- ▬ Paved Highway
- ▬ County Roads
- ▬ Non-highway paved
- ▭ Bureau of Land Management
- ▭ Private
- ▭ State
- ▭ State Fish and Game
- ▭ US Forest Service

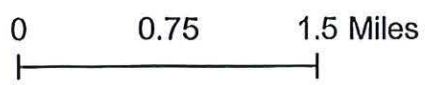

**Bonner-Shoshone
Border
T53N R01E**

R 01 W

R 01 E

R 02 E

T 53 N

T 52 N

T 51 N

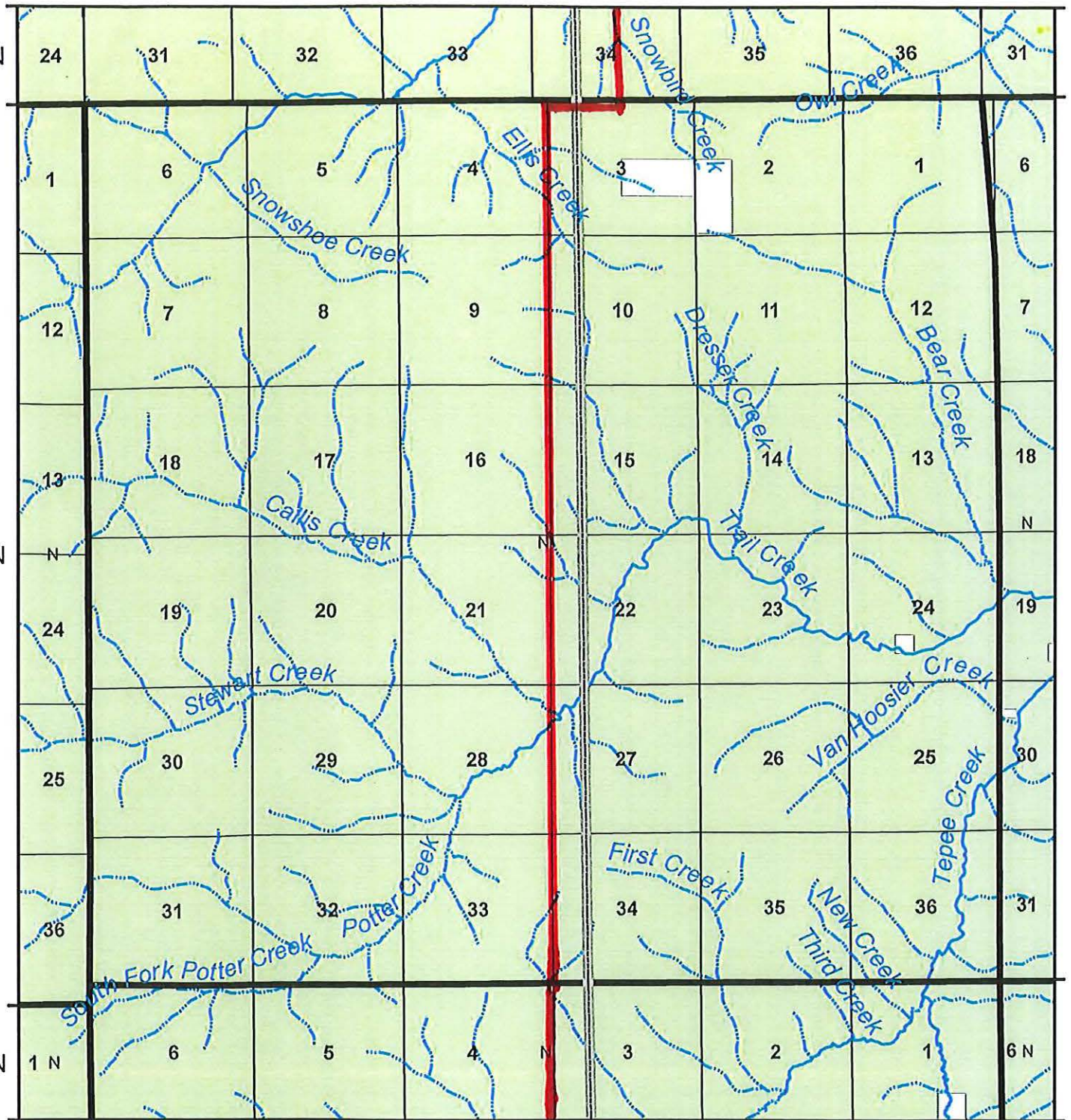

Legend

- Known Established Corner
- Estimated County Line
- ▬ Paved Highway
- ▬▬ County Roads
- ▬ Non-highway paved
- Private
- State
- Bureau of Land Management
- State Fish and Game
- US Forest Service

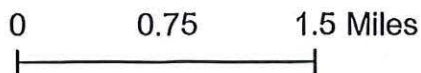
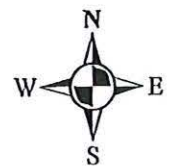

**Kootenai - Shoshone
Border
T52N R01E**

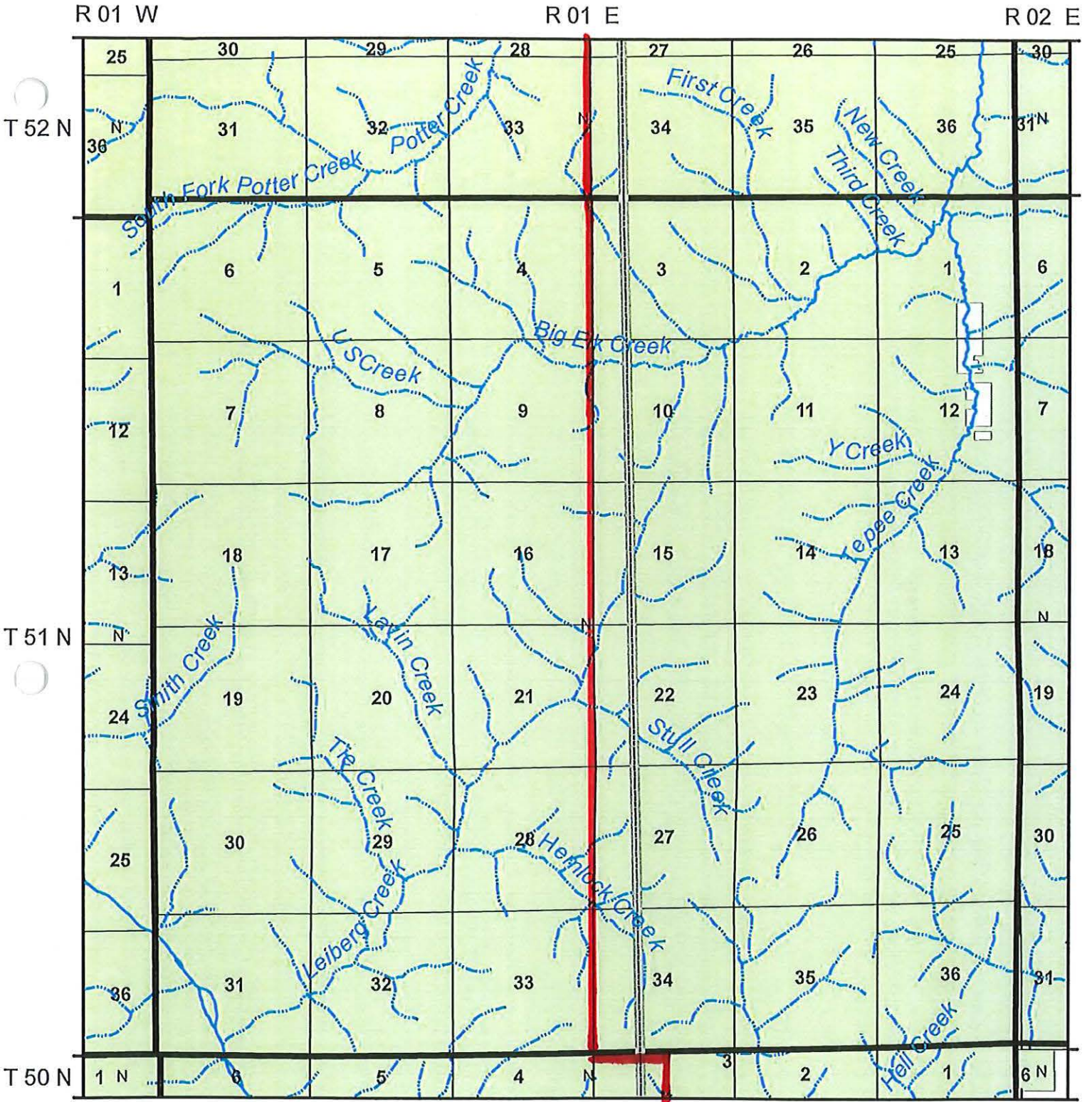

Legend

- Known Established Corner
- Estimated County Line
- ▬ Paved Highway
- ▬▬ County Roads
- ▬ Non-highway paved
- Private
- State
- Bureau of Land Management
- State Fish and Game
- US Forest Service

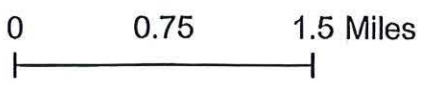

**Kootenai - Shoshone
Border
T51N R01E**

R 01 W

R 01 E

R 02 E

T 51 N

T 50 N

T 49 N

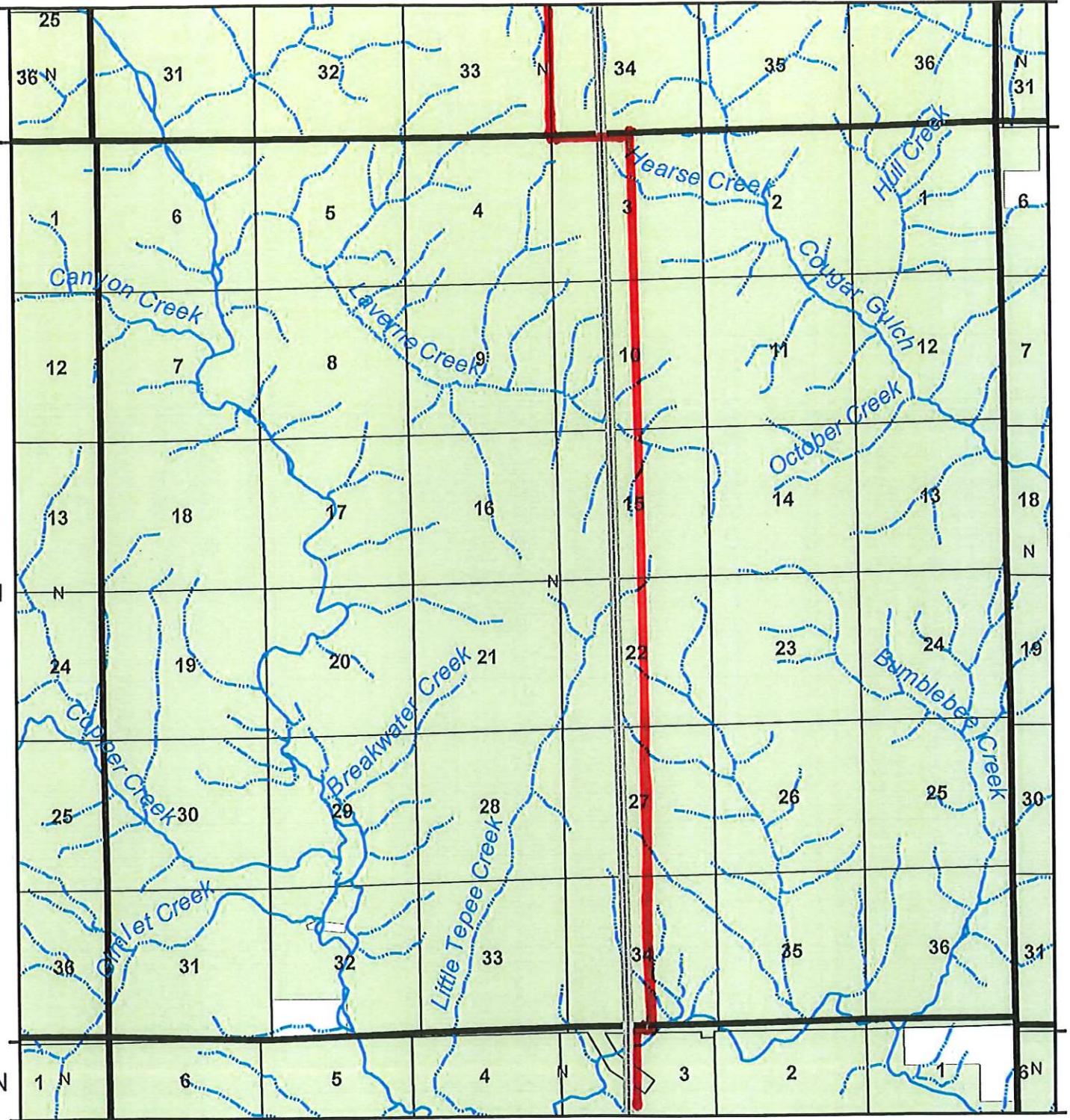

Legend

- Known Established Corner
- Estimated County Line
- ▬ Paved Highway
- ▬ County Roads
- ▬ Non-highway paved
- ▭ Bureau of Land Management
- ▭ Private
- ▭ State
- ▭ State Fish and Game
- ▭ US Forest Service

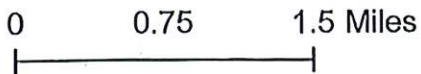

**Kootenai - Shoshone
Border
T50N R01E**

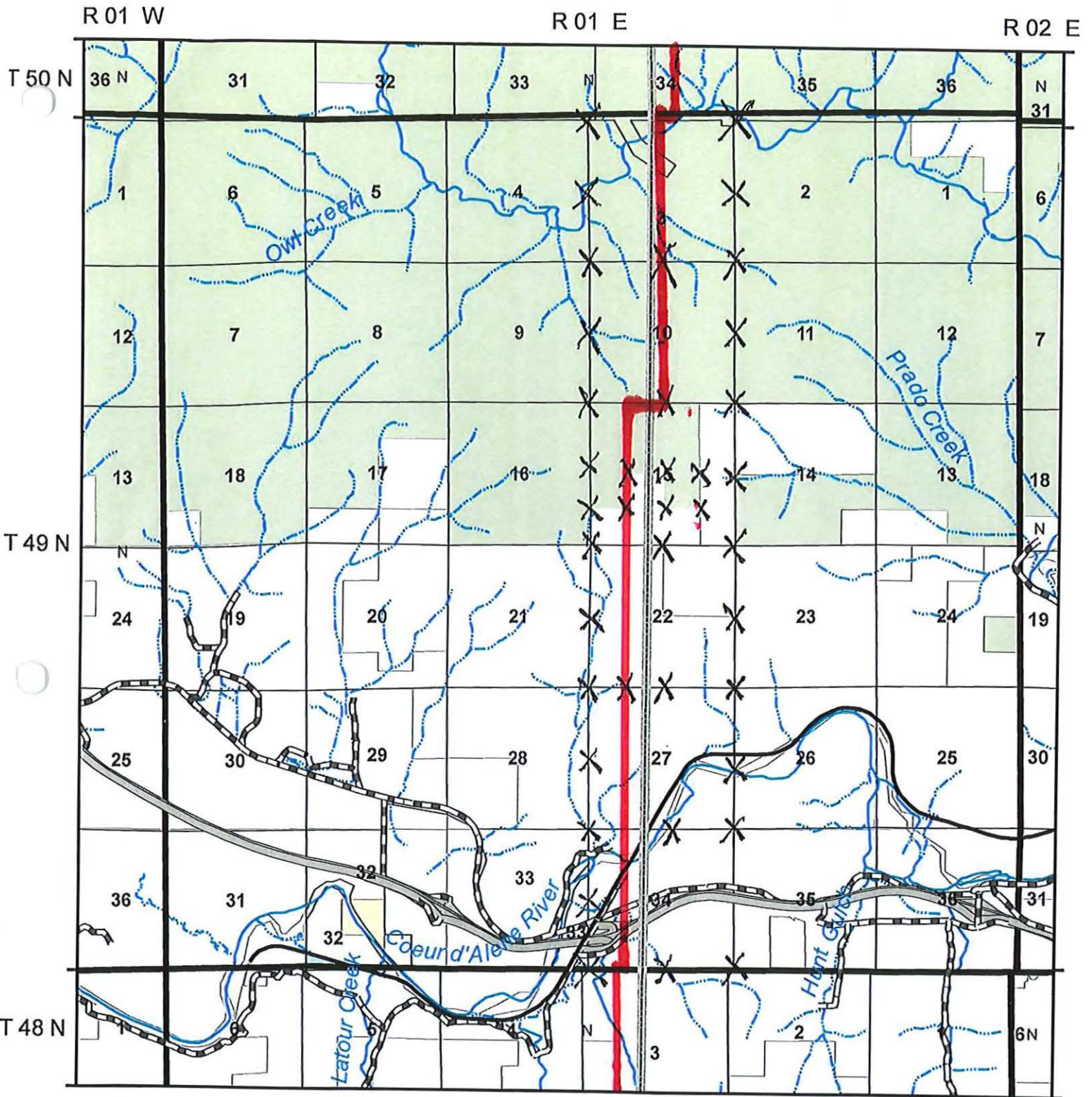

Legend

- Known Established Corner
- Estimated County Line
- Paved Highway
- County Roads
- Non-highway paved
- Bureau of Land Management
- Private
- State
- State Fish and Game
- US Forest Service



**Kootenai - Shoshone
Border
T49N R01E**

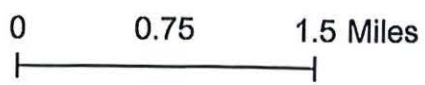

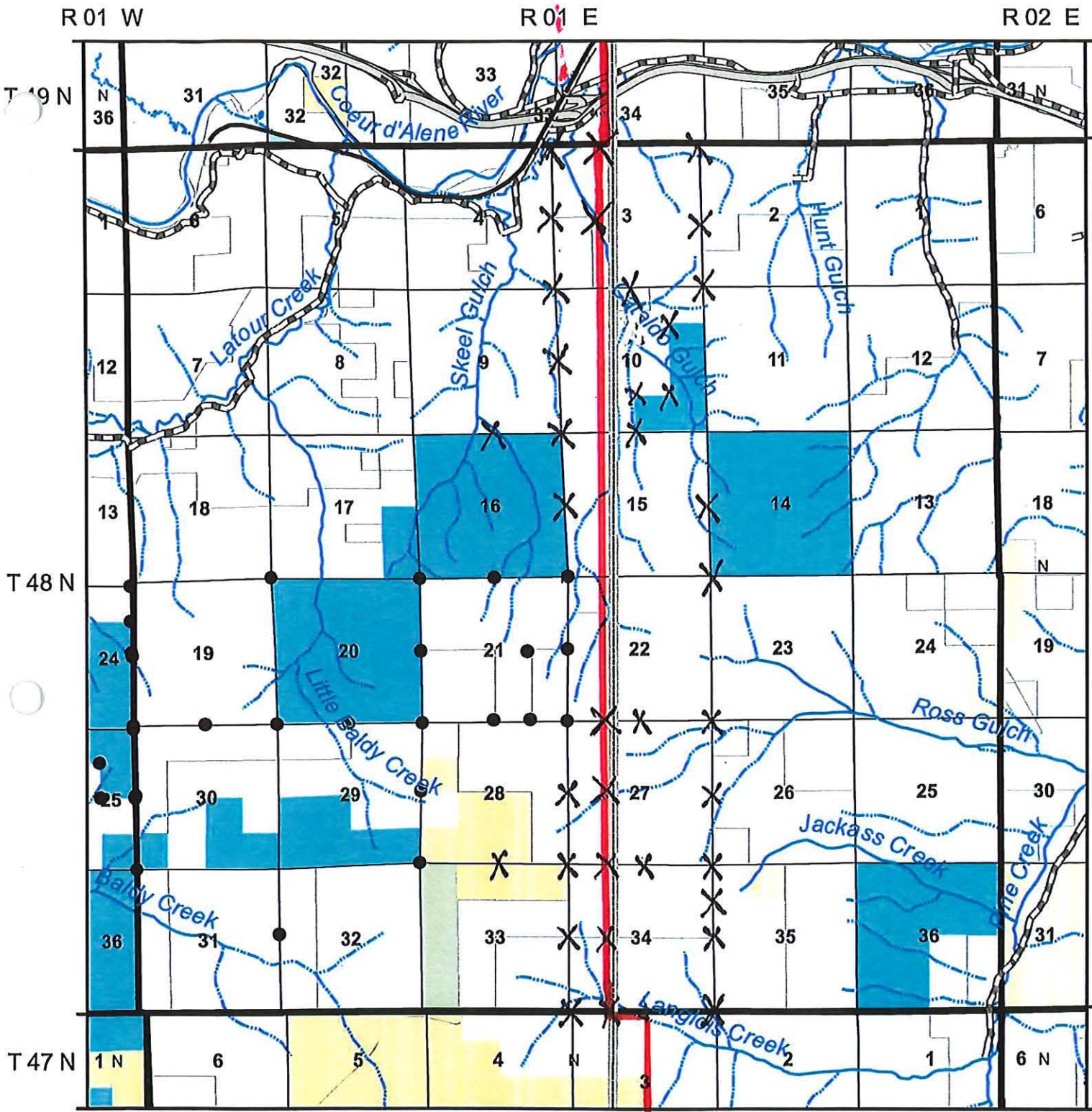

Legend

- | | | | |
|--|--|--|--|
| | | | |
| | | | |
| | | | |

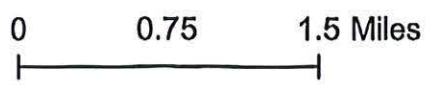

**Kootenai - Shoshone
Border
T48N R01E**

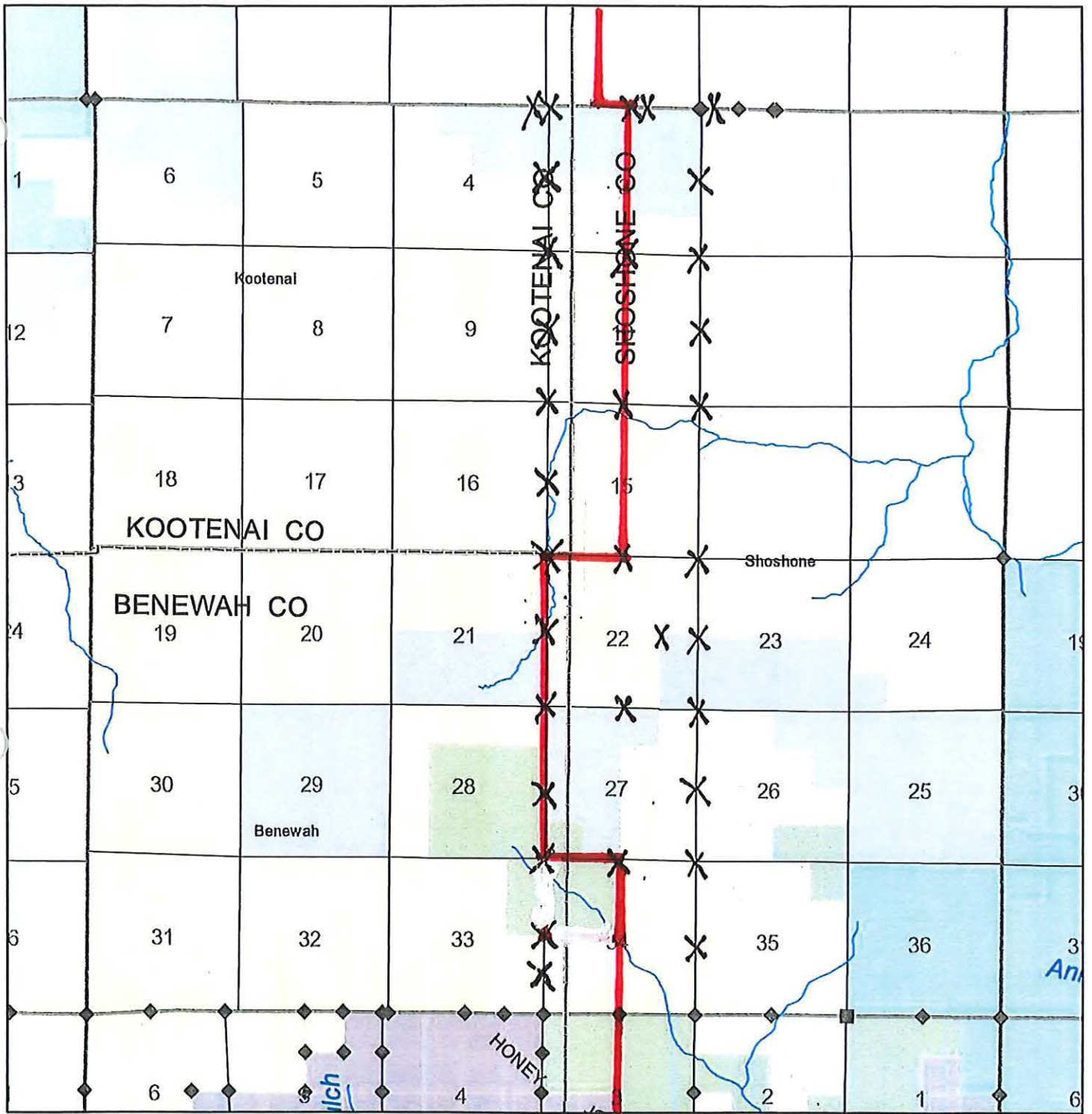

- | | | |
|-------------------------------------|---------------------------|--|
| PotlatchDeltic Land and Lumber, LLC | Idaho Department of Lands | Remonumented Corner |
| Stinson Lumber | Bureau of Land Management | Evidence Found - Needs Remonumentation |
| Hancock | private | No Evidence Found |
| U.S. Forest Service | County Boundary | |

**Benewah - Shoshone
Border
T47NR1E**

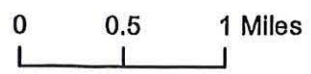

January 29, 2020

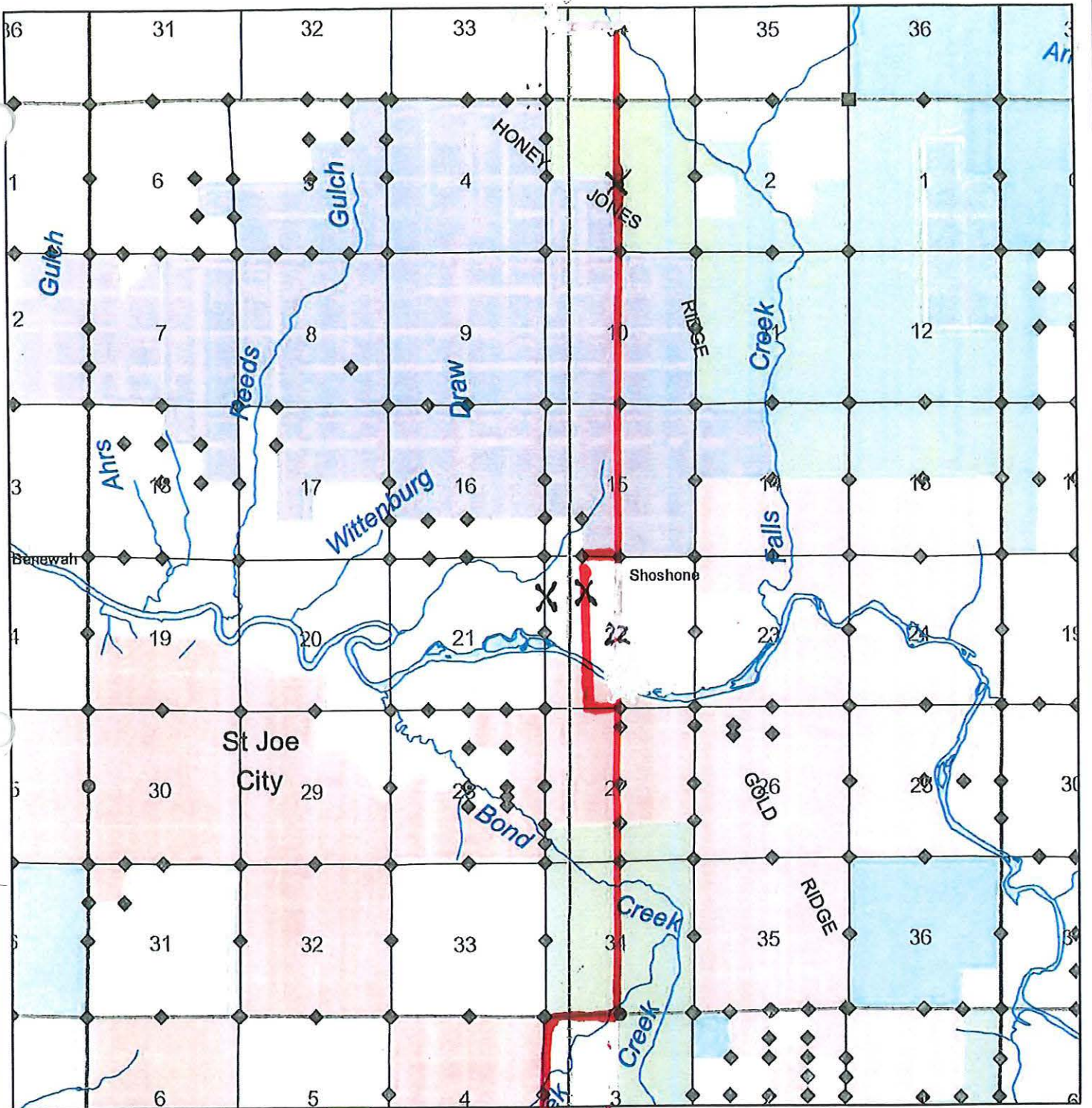

- | | | | |
|--------------------------------------|---------------------------|--|--|
| PotlatchDeltic Forest Holdings, Inc. | U.S. Forest Service | | Remonumented Corner |
| PotlatchDeltic Land and Lumber, LLC | Idaho Department of Lands | | Evidence Found - Needs Remonumentation |
| Inland Empire Paper | Bureau of Land Management | | No Evidence Found |
| Stimson Lumber | private | | |
| Molpus | water | | |
| | County Boundary | | |

**Benewah - Shoshone
Border
T46NR1E**

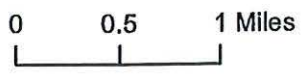

January 29, 2020

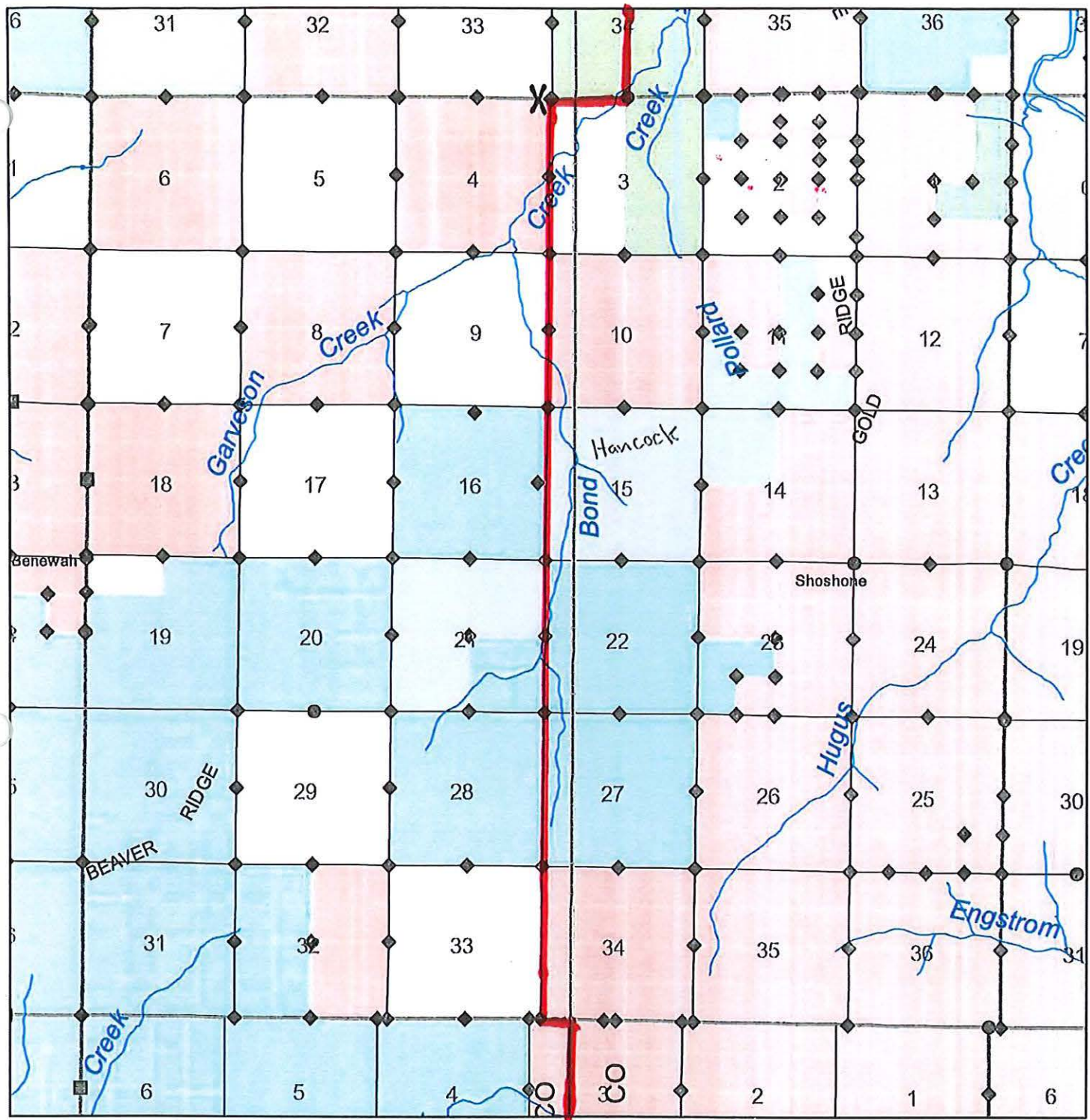





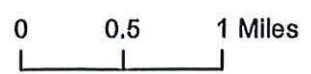



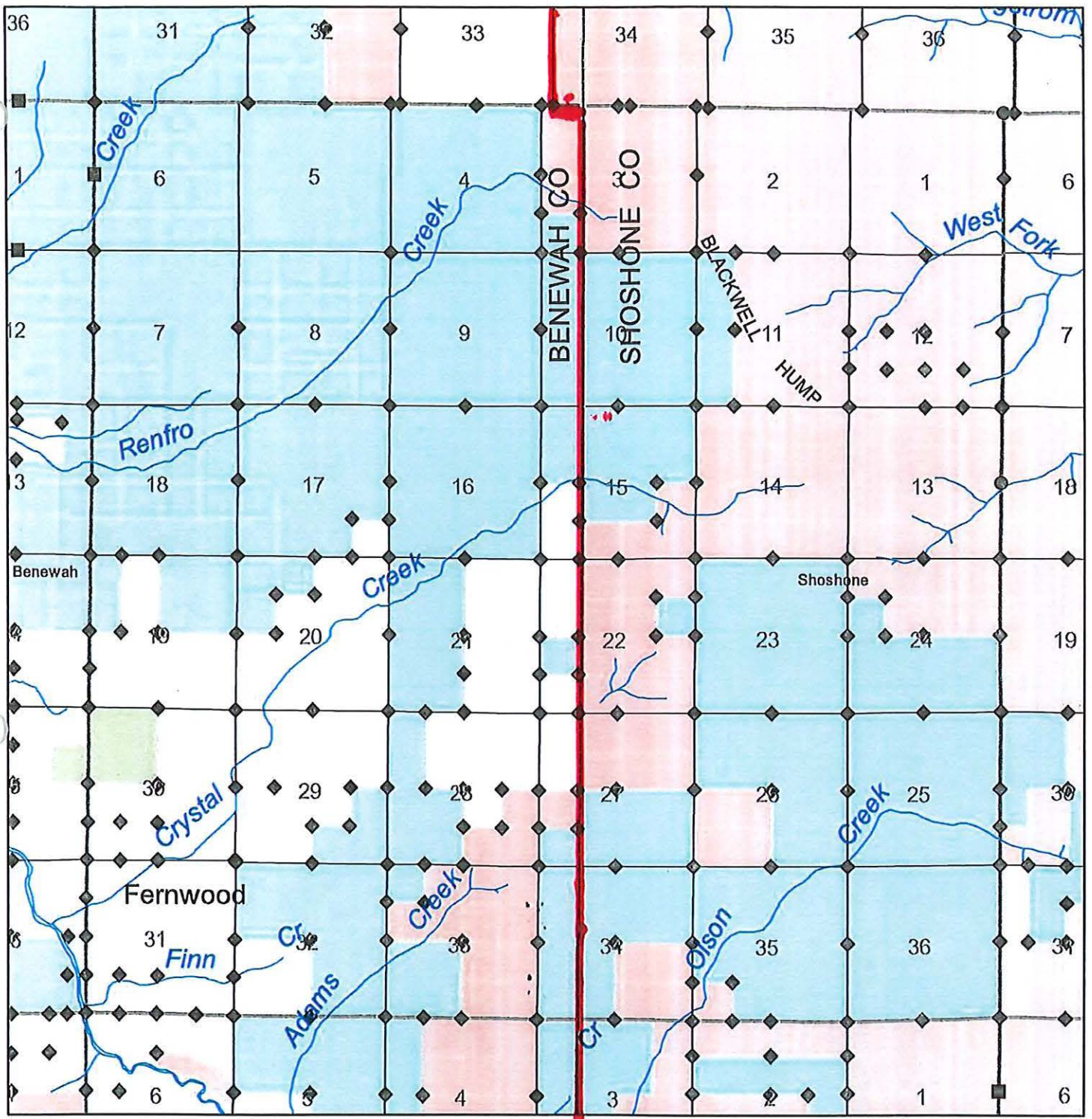



- | | | |
|--------------------------------------|---------------------------|--|
| PotlatchDeltic Forest Holdings, Inc. | U.S. Forest Service | Remonumented Corner |
| Inland Empire Paper | Idaho Department of Lands | Evidence Found - Needs Remonumentation |
| Stimson Lumber | private | No Evidence Found |
| Molpus | water | |
| Hancock | County Boundary | |

**Benewah - Shoshone
Border
T45NR1E**



January 29, 2020



- | | | |
|---|---|--|
|  PotlatchDeltic Forest Holdings, Inc. |  U.S. Forest Service |  Remonumented Corner |
|  Bennett Lumber |  Idaho Department of Lands |  Evidence Found - Needs Remonumentation |
|  Stimson Lumber |  private |  No Evidence Found |
|  Molpus |  County Boundary | |

**Benewah - Shoshone
Border
T44NR1E**

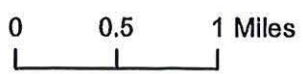

January 29, 2020

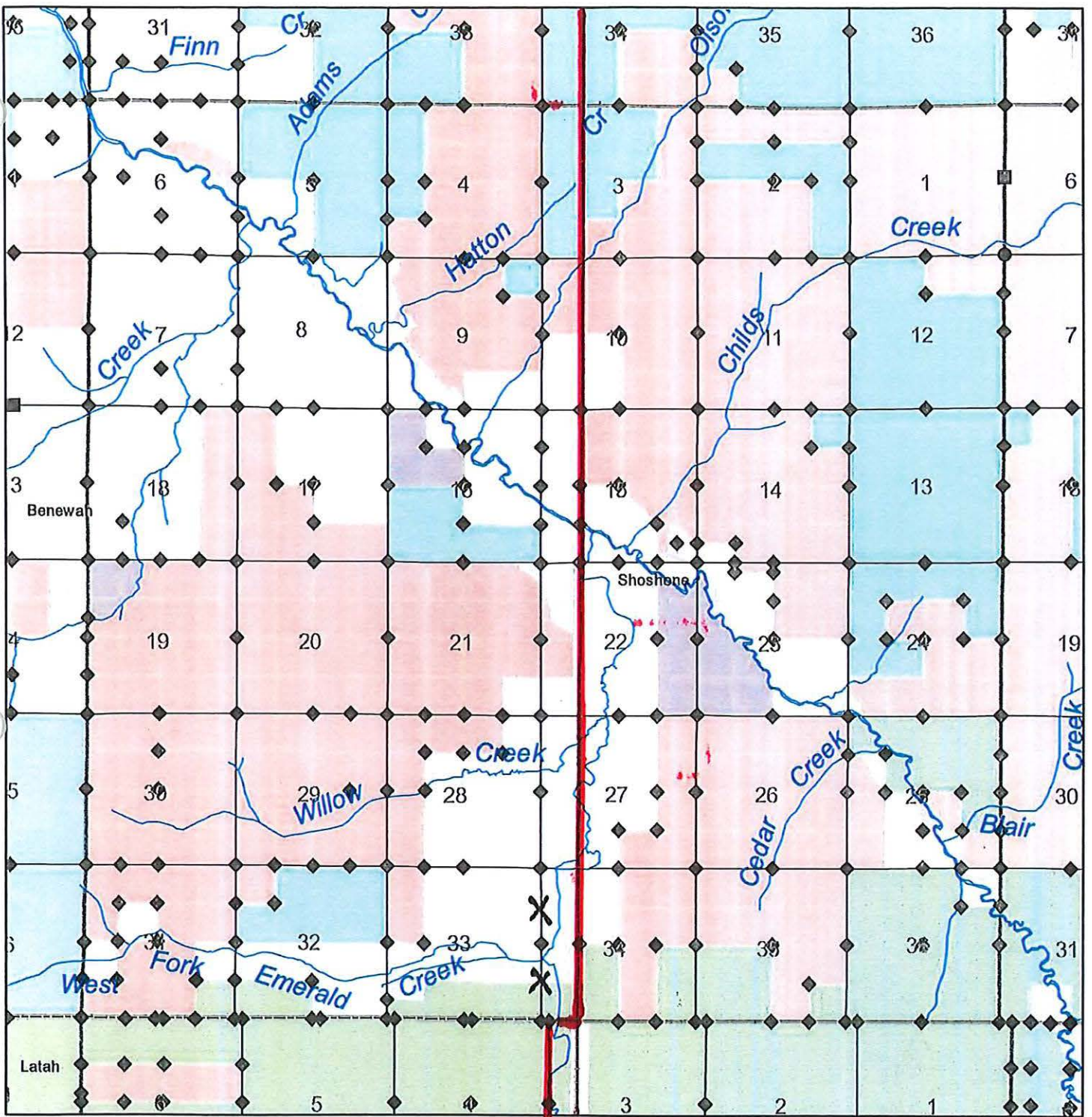

- | | | |
|--------------------------------------|---------------------------|--|
| PotlatchDeltic Forest Holdings, Inc. | Molpus | Remonumented Corner |
| PotlatchDeltic Land and Lumber, LLC | U.S. Forest Service | Evidence Found - Needs Remonumentation |
| PotlatchDeltic TRS Idaho, LLC | Idaho Department of Lands | No Evidence Found |
| Stimson Lumber | private | |
| | County Boundary | |

**Benewah - Shoshone
Border
T43NR1E**



0 0.5 1 Miles



January 29, 2020

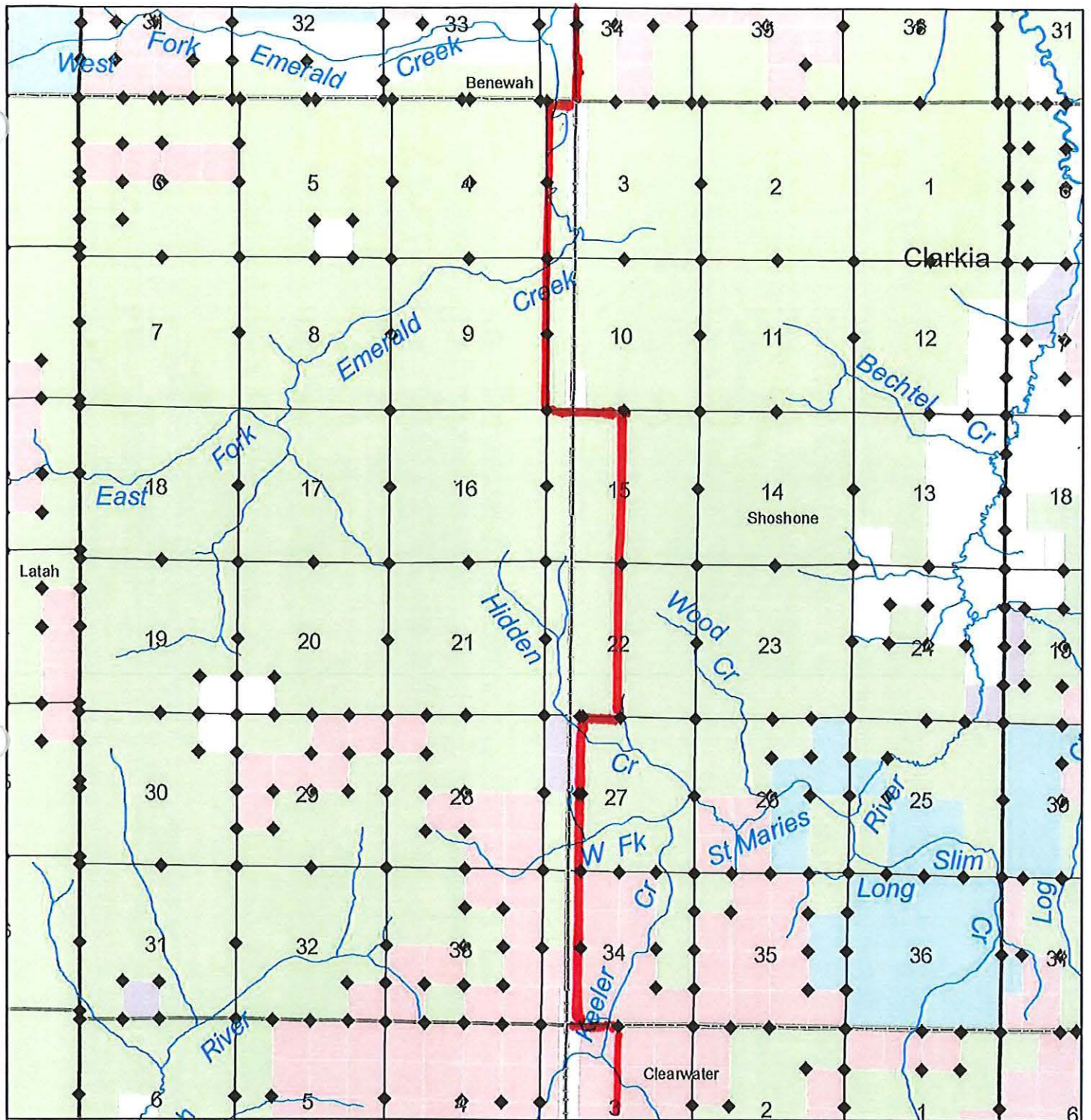

- | | | |
|--------------------------------------|---------------------------|--|
| PollatchDeltic Forest Holdings, Inc. | U.S. Forest Service | Remonumented Corner |
| PollatchDeltic Land and Lumber, LLC | Idaho Department of Lands | Evidence Found - Needs Remonumentation |
| Stimson Lumber | private | No Evidence Found |
| County Boundary | | |

**Latah County
Border
T42NR1E**



0 0.5 1 Miles



November 12, 2019

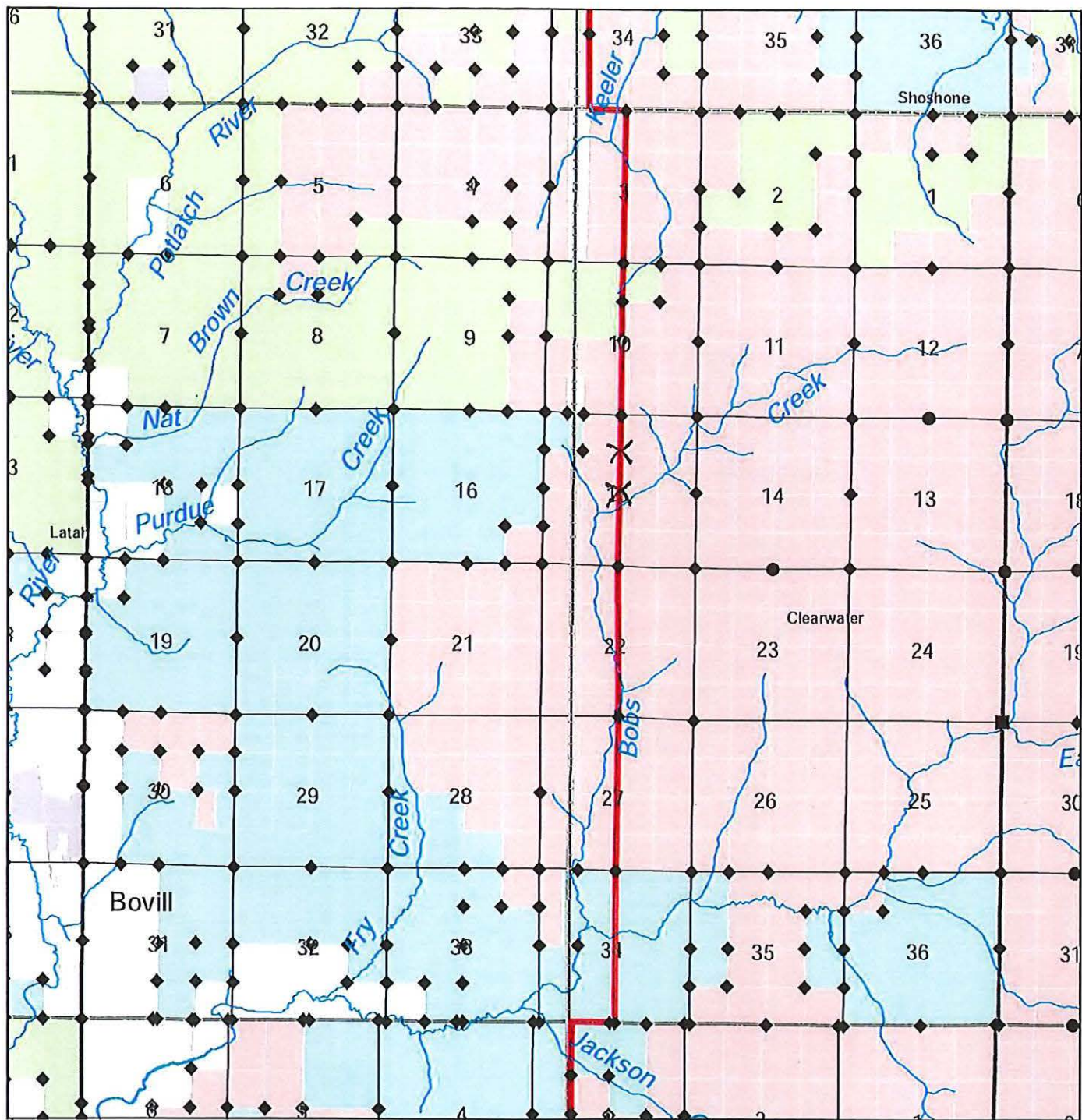

- | | | |
|---|---|--|
|  PottlatchDeltic Forest Holdings, Inc. |  U.S. Forest Service |  Remonumented Corner |
|  PottlatchDeltic Land and Lumber, LLC |  Idaho Department of Lands |  Evidence Found - Needs Remonumentation |
|  Stimson Lumber |  private |  No Evidence Found |
|  County Boundary |  Zig-Zag Hybrid | |

Latah County
 Border
 T41NR1E

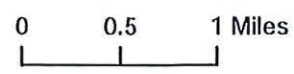

February 12, 2021

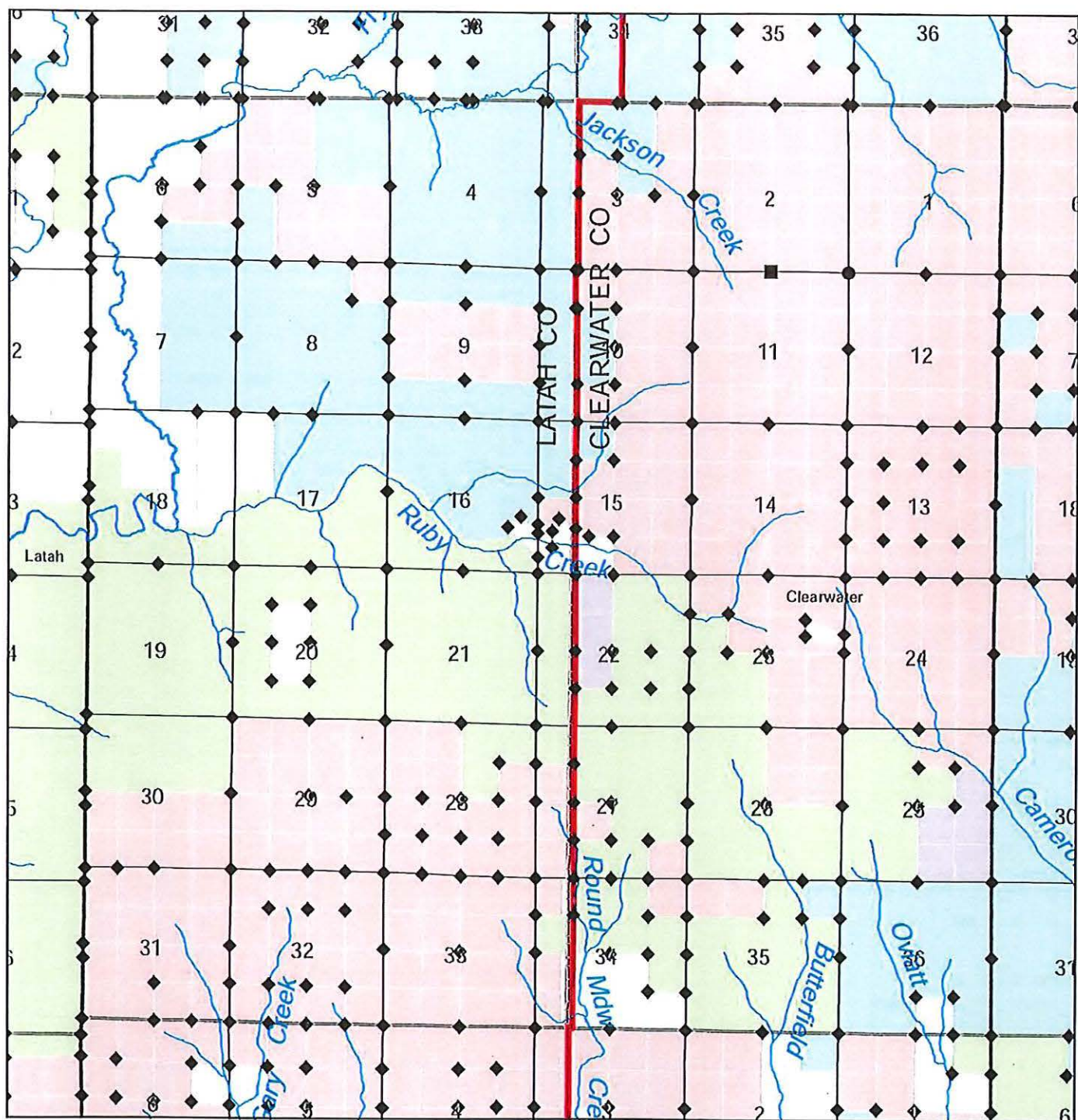

- | | | |
|---|---|--|
|  PottlatchDeltic Forest Holdings, Inc. |  U.S. Forest Service |  Remonumented Corner |
|  PottlatchDeltic Land and Lumber, LLC |  Idaho Department of Lands |  Evidence Found - Needs Remonumentation |
|  Bennett Lumber |  private |  No Evidence Found |
|  Stimson Lumber |  County Boundary | |
| |  Zig-Zag Hybrid | |

Latah County
Border
T40NR1E

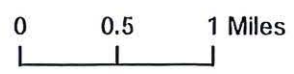

February 12, 2021

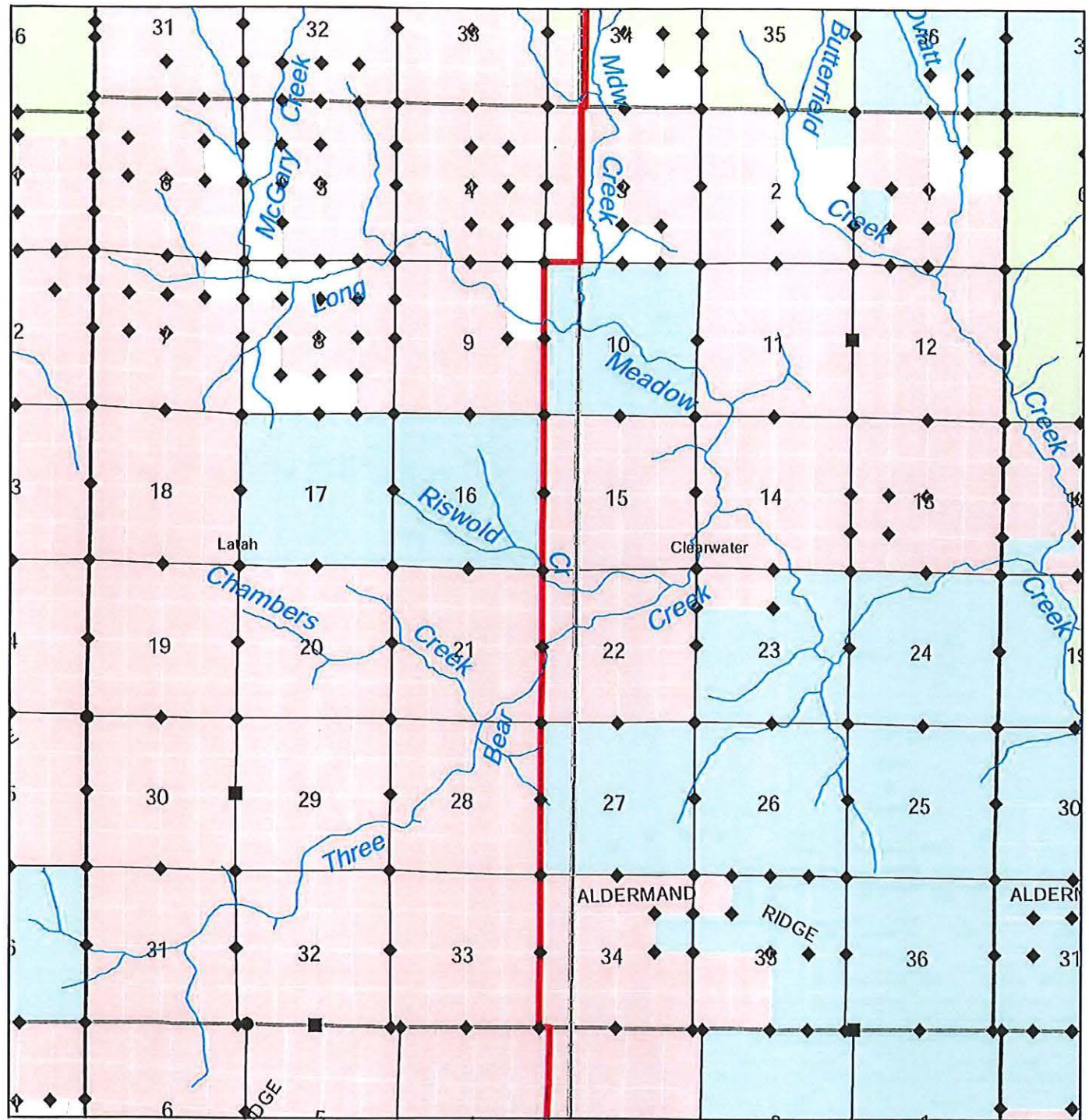

- PotlatchDeltic Forest Holdings, Inc.
- Idaho Department of Lands
- U.S. Forest Service
- private
- County Boundary
- Zig-Zag Hybrid
- Remonumented Corner
- Evidence Found - Needs Remonumentation
- No Evidence Found

*Latah County
Border*
T39NR1E

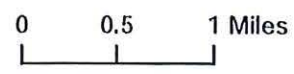

February 12, 2021

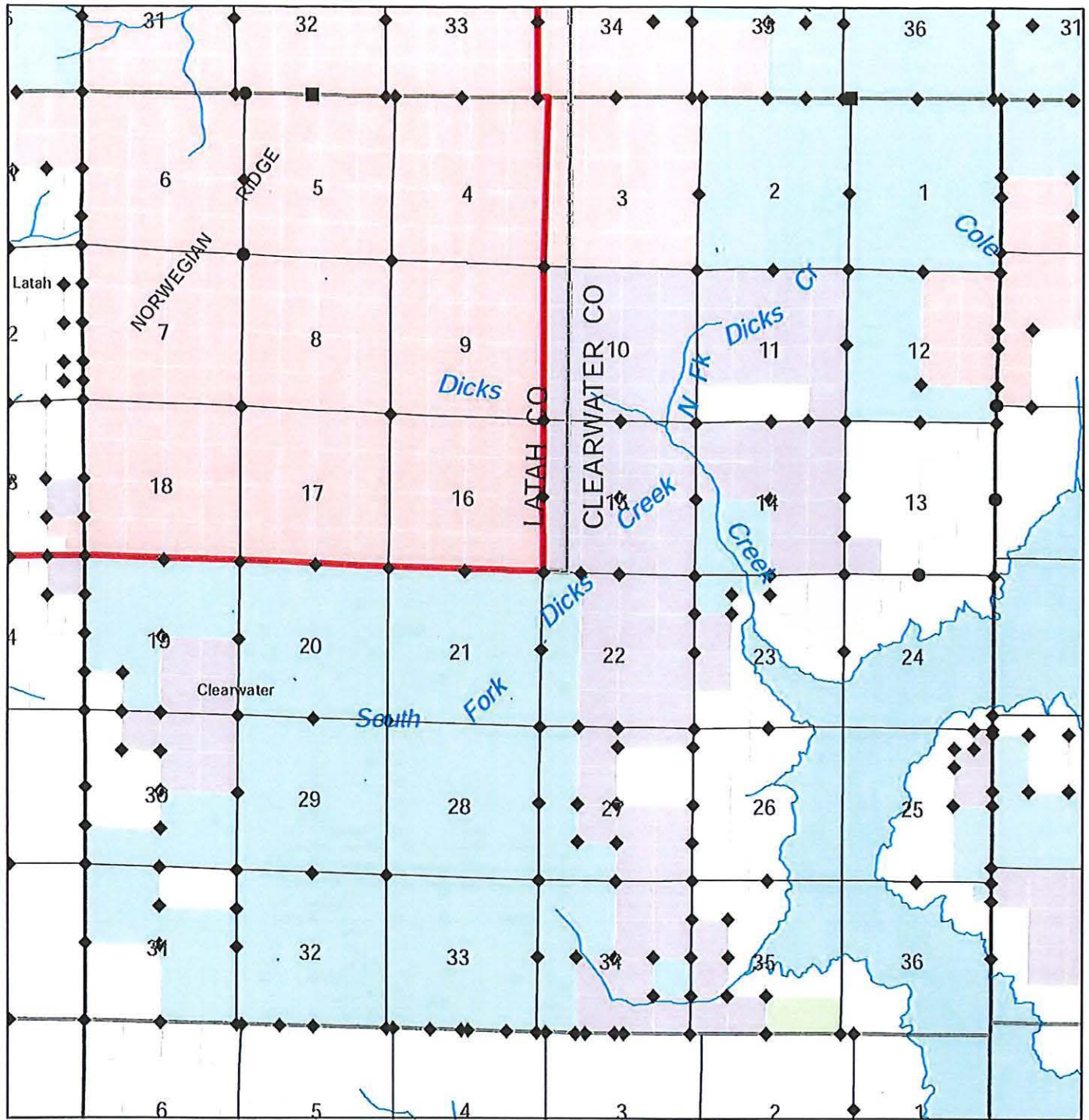

- | | | |
|---------------------------------------|---------------------------|--|
| PottlatchDeltic Forest Holdings, Inc. | Idaho Department of Lands | Remonumented Corner |
| PottlatchDeltic Land and Lumber, LLC | Corps of Engineers | Evidence Found - Needs Remonumentation |
| PottlatchDeltic TRS Idaho, LLC | private | No Evidence Found |
| Bennett Lumber | water | |
| U.S. Forest Service | County Boundary | |
| | Zig-Zag Hybrid | |

Latah County
Border
T38NR1E



0 0.5 1 Miles



February 12, 2021